







## META Single-lever basin mixer without pop-up waste - Dark Chrome

META

33 565 661



- 180° spout
- 165mm projection
- pivotable spout 360°
- circular, air-enriched flow
- height of mixer 310 mm
- height up to aerator 199 mm
- hole diameter 35 mm
- 2x screw-in M 8 x 1 pressure hose, leak-tested
- max. flow 5.7 l/min
- lead-free
- This product can help a building meet the requirements of Green Building Rating Systems, e.g. LEED®, BREEAM®, DGNB

	Dark Chrome	33 565 661-19
	Chrome	33 565 661-00
	Brushed Platinum	33 565 661-06
	Light Gold	33 565 661-26
	Brushed Light Gold	33 565 661-27
	Matte Black	33 565 661-33
	Brushed Dark Brass	33 565 661-39
	Brushed Bronze	33 565 661-42
	Brushed Champagne (22kt Gold)	33 565 661-46
	Champagne (22kt Gold)	33 565 661-47
	Brushed Chrome	33 565 661-93
	Brushed Dark Platinum	33 565 661-99

33 565 661

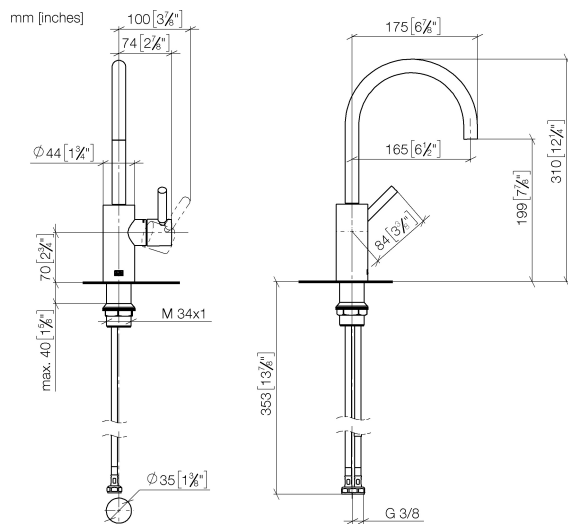

### Flow rate chart



### Codes & Standards

EN 817

Scottish Water  
Byelaws

UK Water Supply  
Regulations



## META Single-lever basin mixer without pop-up waste - Dark Chrome

---

META

33 565 661

### Certificates and sustainability

---

DVGW\_DW-  
6506DN0

WRAS\_250502

33 565 661

Parts for other  
finishes can be found  
here: [Chrome](#)

