

# LOT Single-lever mixer - Brushed Champagne (22kt Gold)

33 800 680    Product version from 3/1/2023

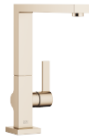

- 236mm projection
- pivotable spout 360°
- air-enriched flow
- max. flow 8 l/min at 3 bar flow pressure
- lead-free
- This product can help a building meet the requirements of Green Building Rating Systems, e.g. LEED®, BREEAM®, DGNB

	Brushed Champagne (22kt Gold)	33 800 680-46
	Chrome	33 800 680-00
	Brushed Platinum	33 800 680-06
	Platinum	33 800 680-08
	Dark Chrome	33 800 680-19
	Brushed Durabronze (23kt Gold)	33 800 680-28
	Champagne (22kt Gold)	33 800 680-47
	Brushed Dark Platinum	33 800 680-99

## Recommended miscellaneous

**Dispenser with rosette - Brushed Champagne (22kt Gold)**    82 439 970-46



## Recommended miscellaneous

**Strainer waste with control handle - Brushed Champagne (22kt Gold)**    10 711 970-46



## LOT Single-lever mixer - Brushed Champagne (22kt Gold)

33 800 680 Product version from 3/1/2023

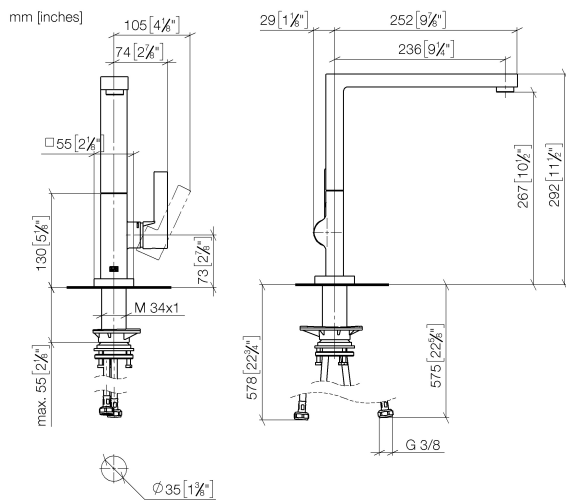

### Flow rate chart

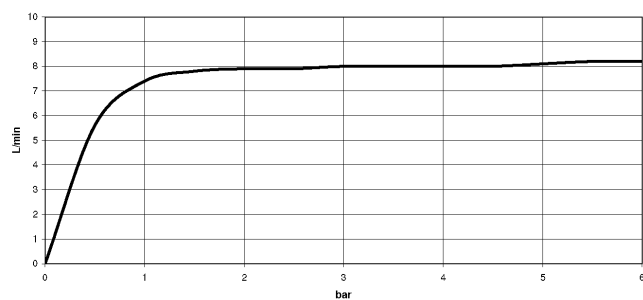

### Codes & Standards

DIN 4109

ISO 3822

Ü-Zeichen



## LOT Single-lever mixer - Brushed Champagne (22kt Gold)

---

33 800 680 Product version from 3/1/2023

### Certificates

---

LGA\_38

**LOT Single-lever mixer - Brushed Champagne (22kt Gold)**

33 800 680 Product version from 3/1/2023

Parts for other  
finishes can be found  
here: [Chrome](#)

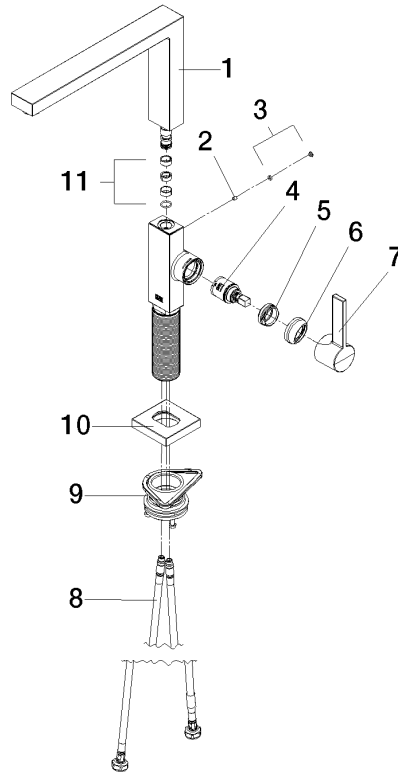

**Spare parts list**

No.	Item Number	Name	Quantity used	Delivery time
1	90 11 06 218 00-46	spout	1	-
Spare part can no longer be ordered, please order the replacement item				
2	09 31 11 044 90	pin	1	2
3	90 31 20 087 00-46	plug	1	30
4	90 15 05 042 00 90	cartridge	1	2
5	09 24 04 266 90	nut	1	2
6	90 28 30 052 00-46	cover	1	30
7	90 20 86 004 00-46	handle	1	30
8	04 30 04 101 00 90	hose	2	2
9	90 30 10 057 00 90	fixing set	1	-
Spare part can no longer be ordered, please order the replacement item				
10	90 27 86 004 00-46	rosette	1	-
Spare part can no longer be ordered, please order the replacement item				
11	90 28 10 207 00 90	gasket kit	1	2