

## META SQUARE Single-lever mixer - Brushed Champagne (22kt Gold)

META SQUARE

33 815 861 Product version from 2/1/2023



- 235mm projection
- pivotable spout 360°
- Optional swivel limiter available with swivel limiter set 12 820 970 90
- air-enriched flow
- max. flow 8 l/min at 3 bar flow pressure
- lead-free
- This product can help a building meet the requirements of Green Building Rating Systems, e.g. LEED®, BREEAM®, DGNB
- WRAS

|  |                               |               |
|--|-------------------------------|---------------|
|  | Brushed Champagne (22kt Gold) | 33 815 861-46 |
|  | Chrome                        | 33 815 861-00 |
|  | Brushed Platinum              | 33 815 861-06 |
|  | Platinum                      | 33 815 861-08 |
|  | Durabrand (23kt Gold)         | 33 815 861-09 |
|  | Dark Chrome                   | 33 815 861-19 |
|  | Brushed Durabrand (23kt Gold) | 33 815 861-28 |
|  | Matte Black                   | 33 815 861-33 |
|  | Champagne (22kt Gold)         | 33 815 861-47 |
|  | Brushed Chrome                | 33 815 861-93 |
|  | Brushed Dark Platinum         | 33 815 861-99 |

### Recommended miscellaneous

**Swivel limitation set -** 12 820 970 90



### Recommended miscellaneous

**Strainer waste with control handle - Brushed Champagne (22kt Gold)** 10 712 970-46



### Recommended miscellaneous

**Dispenser without rosette - Brushed Champagne (22kt Gold)** 82 424 970-46



33 815 861 Product version from 2/1/2023

mm [inches]



### Flow rate chart



### Codes & Standards

DIN 4109

ISO 3822

Scottish Water  
Byelaws

UK Water Supply  
Regulations

### Ü-Zeichen



## META SQUARE Single-lever mixer - Brushed Champagne (22kt Gold)

META SQUARE

33 815 861 Product version from 2/1/2023

### Certificates

LGA\_38

WRAS\_240102

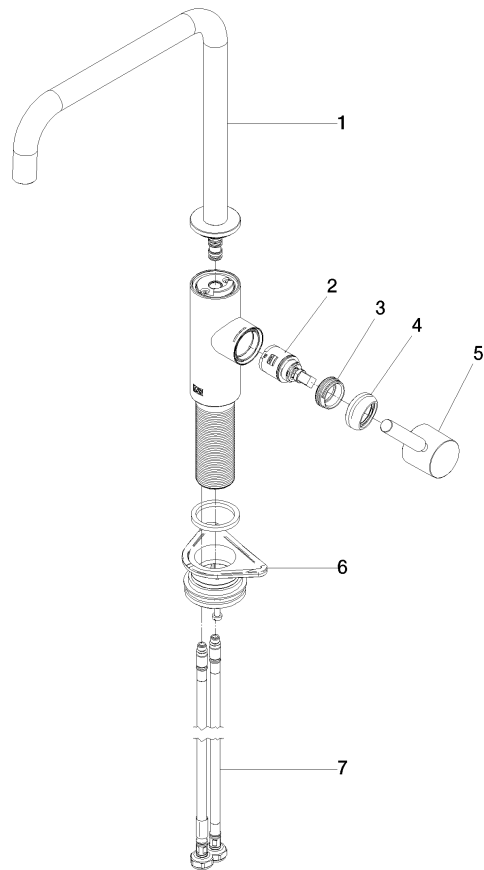

### Spare parts list

| No. | Item Number        | Name       | Quantity used | Delivery time |
|-----|--------------------|------------|---------------|---------------|
| 1   | 90 28 22 284 00-46 | spout      | 1             | 30            |
| 2   | 90 15 05 042 00 90 | cartridge  | 1             | 2             |
| 3   | 09 24 04 266 90    | nut        | 1             | 2             |
| 4   | 90 28 30 052 00-46 | cover      | 1             | 30            |
| 5   | 90 20 66 033 00-46 | handle     | 1             | 30            |
| 6   | 04 23 10 044 08 90 | fixing set | 1             | 2             |
| 7   | 04 30 04 101 00 90 | hose       | 2             | 2             |