

VAIA Single-lever mixer for rinsing/Profi spray - Brushed Chrome











VAIA

33 826 809



- 241mm projection
- pivotable spout 360°
- air-enriched flow
- max. flow 7 l/min at 3 bar flow pressure
- lead-free
- This product can help a building meet the requirements of Green Building Rating Systems, e.g. LEED®, BREEAM®, DGNB

Single-lever mixer for combining with rinsing/Profi spray only

	Brushed Chrome	33 826 809-93
	Chrome	33 826 809-00
	Brushed Platinum	33 826 809-06
	Platinum	33 826 809-08
	Durabrand (23kt Gold)	33 826 809-09
	Dark Chrome	33 826 809-19
	Brushed Durabrand (23kt Gold)	33 826 809-28
	Matte Black	33 826 809-33
	Brushed Champagne (22kt Gold)	33 826 809-46
	Champagne (22kt Gold)	33 826 809-47
	Brushed Dark Platinum	33 826 809-99

Recommended miscellaneous

VAIA Dispenser with rosette -
Brushed Chrome

82 434 809-93



Recommended miscellaneous

VAIA Rinsing spray set - Brushed
Chrome

27 718 809-93



33 826 809

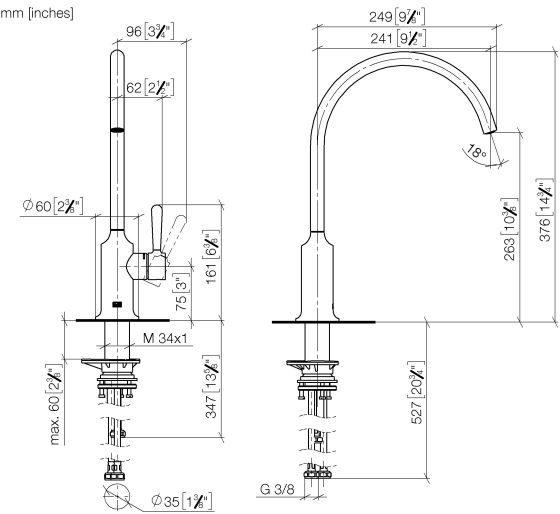

Flow rate chart

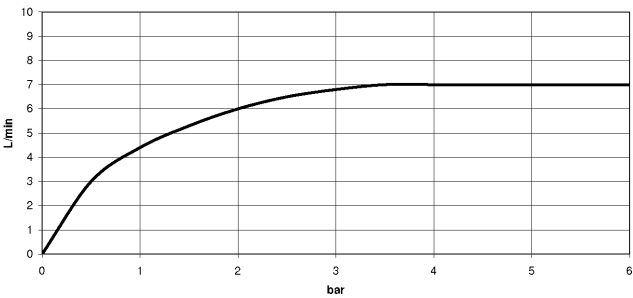

Codes & Standards

DIN 4109

ISO 3822

Ü-Zeichen



VAIA Single-lever mixer for rinsing/Profi spray - Brushed Chrome

VAIA

33 826 809

Certificates

LGA_38

33 826 809

Product version from 7/1/2023

Parts for other
finishes can be found
here: [Chrome](#)

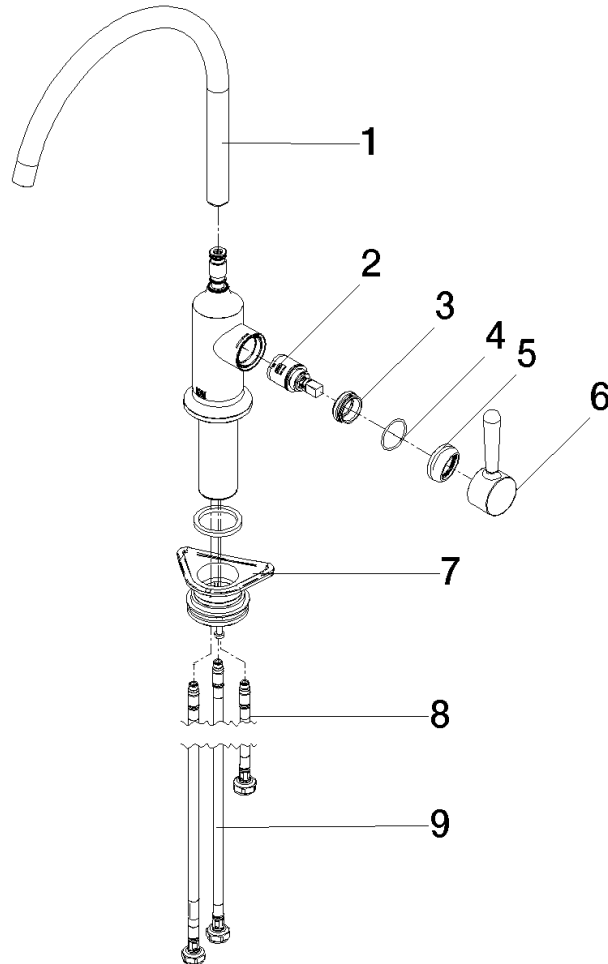



VAIA Single-lever mixer for rinsing/Profi spray - Brushed Chrome

VAIA

33 826 809

Spare parts list

Product version from 7/1/2023

No.	Item Number	Name	Quantity used	Delivery time
	90 28 22 396 00-93	spout	10	60