



- concealed rough parts
- flush-mounted reflection box, 662 x 482 mm, RAL 9003, Signal White
- 2x female thread 1/2" connections
- min. recess depth 150 mm
- max. recess depth 590 mm
- weight 15kg

Separate LED power supply

Input LED power supply

- Electricity supply: 100-240 V AC, 50-60 Hz, 20 W

Output LED power supply

- 24V DC (CV)

Output specification LED power supply

- SELV (Safety Extra Low Voltage)
- Class 2

Ceiling module power supply

- 24V DC (CV)
- Supply pipe 7 m

Activation

- ZigBee Light Link RGBW controller
- Provided by customer: Zigbee gateway

Environment

- Not suitable for outdoor use.
- Not suitable for use in a steam room.
- Not suitable for use in chlorinated or salty environments.
- Comply with the protection zone regulations as defined in DIN VDE 0100, Part 701 (IEC 60364-7-701).
- Dornbracht recommends consulting a systems integrator.

Recommended miscellaneous

Leak protection 1/2" -

12 010 970 90

- This article is needed 2x.



35 771 970 90 Product version from 9/1/2024

mm [inches]

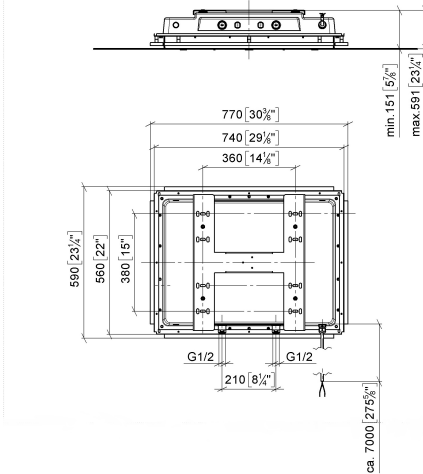

Codes & Standards

Scottish Water
Byelaws

UK Water Supply
Regulations

Certificates and sustainability

WRAS_250102

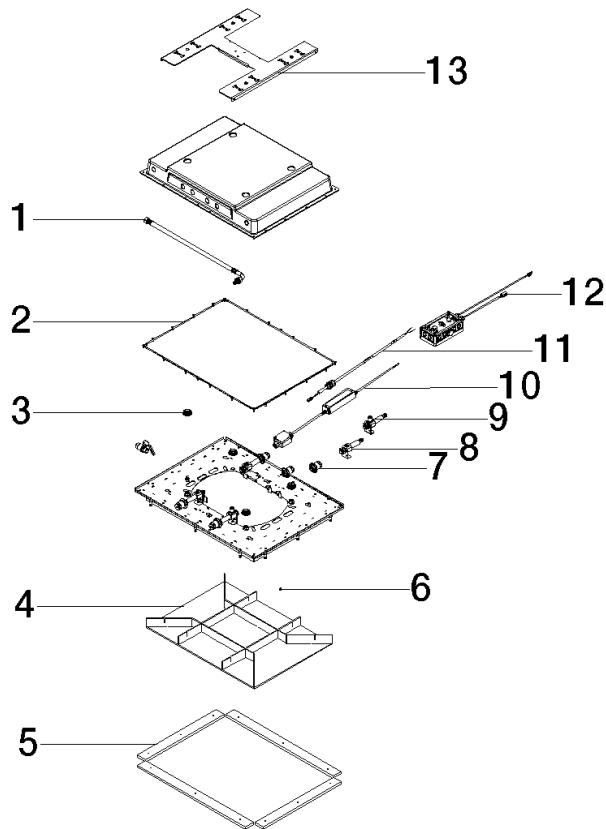

Spare parts list

| No. | Item Number | Name | Quantity used | Delivery time |
|-----|--------------------|------------------------|---------------|---------------|
| 9 | 90 17 20 308 00 90 | connection | 1.00 | 2 |
| 5 | 90 18 30 020 00 90 | sleeve | 1.00 | 2 |
| 2 | 90 14 03 194 00 90 | seal | 1.00 | 2 |
| 12 | 90 10 01 264 00 90 | electronic accessories | 1.00 | 2 |
| 11 | 90 10 01 228 00 90 | electronic accessories | 1.00 | 2 |
| 4 | 90 91 42 195 01 90 | lid | 1.00 | 2 |
| 8 | 90 17 20 308 01 90 | connection | 1.00 | 2 |
| 10 | 90 10 01 262 00 90 | electronic accessories | 1.00 | 2 |
| 3 | 91 31 20 530 00 90 | nipple set | 1.00 | 2 |
| 6 | 91 30 30 194 00 90 | screw | 1.00 | 2 |
| 13 | 90 17 20 304 00 90 | holder | 1.00 | 2 |
| 7 | 90 24 03 305 00 90 | fixing set | 1.00 | 2 |
| 1 | 90 30 04 099 00 90 | hose | 1.00 | 2 |