

MEM Concealed three-way diverter - Brushed Platinum

MEM

36 210 782

Product version from 4/1/2022



- rotary diverter
- rosette 60 x 60 mm
- WRAS

	Brushed Platinum	36 210 782-06
	Chrome	36 210 782-00
	Platinum	36 210 782-08
	Dark Chrome	36 210 782-19
	Brushed Durabrass (23kt Gold)	36 210 782-28
	Brushed Champagne (22kt Gold)	36 210 782-46
	Champagne (22kt Gold)	36 210 782-47
	Brushed Dark Platinum	36 210 782-99

Required miscellaneous

	<div>Concealed three-way diverter -</div> <div> <div>•max. recess depth 160 mm</div> <div>•min. recess depth 115 mm</div> </div>	35 203 970 90
--	--	---------------

36 210 782    Product version from 4/1/2022

mm [inches]

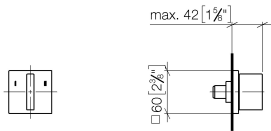

Flow rate chart



Codes & Standards

DIN 4109	ISO 3822	Scottish Water Byelaws	UK Water Supply Regulations
----------	----------	------------------------	-----------------------------

Ü-Zeichen



## MEM Concealed three-way diverter - Brushed Platinum

---

MEM

36 210 782 Product version from 4/1/2022

Certificates and sustainability

---

LGA\_38

WRAS\_2307

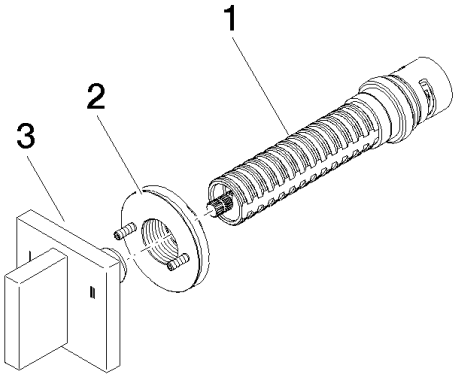

Spare parts list

No.	Item Number	Name	Quantity used	Delivery time
1	90 90 03 303 10 90	diverter	1.00	2
3	90 20 78 002 10-06	handle	1.00	10
2	90 21 02 181 00 90	disc	1.00	2