

META Wall valve clockwise closing 1/2" - Dark Chrome

META

36 607 661

Product version from 7/1/2023

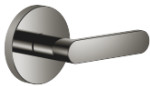

- rosette Ø 60 mm
- head part with cut-to-length spindle and sleeve
- WRAS

| | | |
|---|-------------------------------|---------------|
|  | Dark Chrome | 36 607 661-19 |
|  | Chrome | 36 607 661-00 |
|  | Brushed Platinum | 36 607 661-06 |
|  | Light Gold | 36 607 661-26 |
|  | Brushed Light Gold | 36 607 661-27 |
|  | Matte Black | 36 607 661-33 |
|  | Brushed Bronze | 36 607 661-42 |
|  | Brushed Champagne (22kt Gold) | 36 607 661-46 |
|  | Champagne (22kt Gold) | 36 607 661-47 |
|  | Brushed Chrome | 36 607 661-93 |
|  | Brushed Dark Platinum | 36 607 661-99 |

Required miscellaneous



- Wall valve 1/2" -

•max. recess depth 145 mm

•min. recess depth 85 mm

35 607 970 90



META Wall valve clockwise closing 1/2" - Dark Chrome

META

36 607 661 Product version from 7/1/2023

mm [inches]

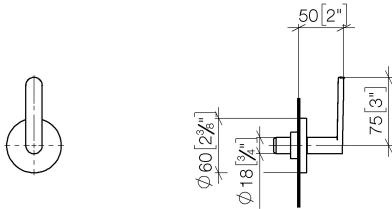

Codes & Standards

| | | | |
|------------------------|-----------------------------|-----------|----------|
| ASME A112.18.1 | cUPC | DIN 4109 | ISO 3822 |
| Scottish Water Byelaws | UK Water Supply Regulations | Ü-Zeichen | |

Certificates and sustainability

| | | | | |
|--------|--------|-----------|--------|--------------|
| LGA_38 | LGA_29 | WRAS_2010 | LGA_29 | IAPMO_4976 (|
|--------|--------|-----------|--------|--------------|

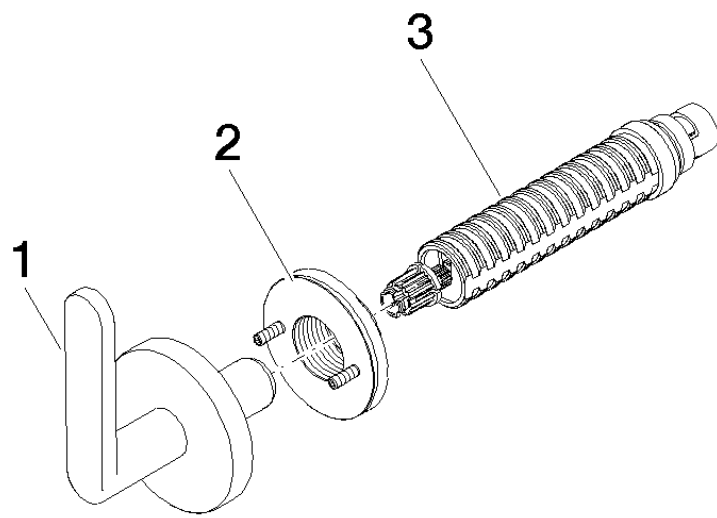

Spare parts list

| No. | Item Number | Name | Quantity used | Delivery time |
|-----|--------------------|--------|---------------|---------------|
| 1 | 90 20 66 014 04-19 | handle | 1.00 | 20 |
| 3 | 90 90 03 143 00 90 | top | 1.00 | 2 |
| 2 | 90 21 02 181 00 90 | disc | 1.00 | 2 |