



META Wall valve clockwise closing 1/2" - Brushed Chrome

META

36 607 661 Product version from 7/1/2023

mm [inches]

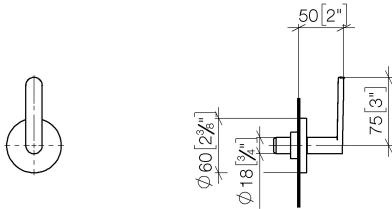

Codes & Standards

ASME A112.18.1	cUPC	DIN 4109	ISO 3822
Scottish Water Byelaws	UK Water Supply Regulations	Ü-Zeichen	

Certificates and sustainability

LGA_38	LGA_29	WRAS_2010	LGA_29	IAPMO_4976 (
--------	--------	-----------	--------	--------------

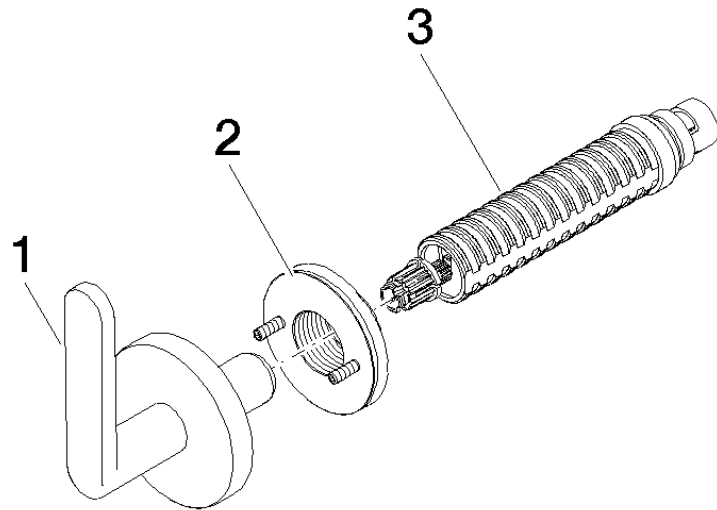

Spare parts list

No.	Item Number	Name	Quantity used	Delivery time
3	90 90 03 143 00 90	top	1.00	2
2	90 21 02 181 00 90	disc	1.00	2
1	90 20 66 014 04-93	handle	1.00	20