

CL.1 Wall valve clockwise closing cold 1/2" - Champagne (22kt Gold)

CL.1

36 607 706    Product version from 10/14/2020



- rosette 60 x 60 mm
- with cold marking
- head part with cut-to-length spindle and sleeve
- WRAS

	Champagne (22kt Gold)	36 607 706-47
	Chrome	36 607 706-00
	Brushed Platinum	36 607 706-06
	Dark Chrome	36 607 706-19
	Brushed Champagne (22kt Gold)	36 607 706-46
	Brushed Dark Platinum	36 607 706-99

Required miscellaneous

	<div> <div>Wall valve 1/2" -</div> <div> <div>•max. recess depth 150 mm</div> <div>•min. recess depth 105 mm</div> </div> </div> <div>35 607 970 90</div>
---	---

CL.1 Wall valve clockwise closing cold 1/2" - Champagne (22kt Gold)

CL.1

36 607 706    Product version from 10/14/2020

mm [inches]



Codes & Standards			
DIN 4109	ISO 3822	Scottish Water Byelaws	UK Water Supply Regulations
Ü-Zeichen			

Certificates and sustainability	
LGA_29	WRAS_2010

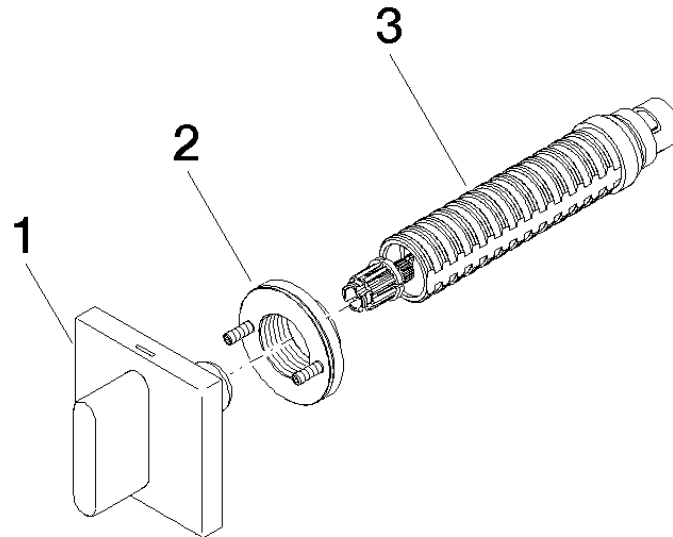

## Spare parts list

No.	Item Number	Name	Quantity used	Delivery time
1	90 20 70 051 02-47	handle ( cold )	1.00	30
2	90 21 02 108 00 90	disc	1.00	2
3	90 90 03 143 00 90	top	1.00	2