



CL.1 Wall valve clockwise closing 1/2" - Brushed Platinum

CL.1

36 627 705    Product version up to 10/14/2020



- with CASCADE structure
- rosette 60 x 60 mm
- without marking
- head part with cut-to-length spindle and sleeve
- WRAS

	Brushed Platinum	36 627 705-06
	Chrome	36 627 705-00
	Dark Chrome	36 627 705-19
	Brushed Champagne (22kt Gold)	36 627 705-46
	Champagne (22kt Gold)	36 627 705-47
	Brushed Dark Platinum	36 627 705-99

Required miscellaneous

	<b>Wall valve 1/2" -</b>	35 607 970 90
	<ul style="list-style-type: none"> <li>• max. recess depth 150 mm</li> <li>• min. recess depth 105 mm</li> </ul>	

CL.1 Wall valve clockwise closing 1/2" - Brushed Platinum

CL.1

36 627 705    Product version up to 10/14/2020

mm [inches]



Codes & Standards			
ASME A112.18.1	cUPC	DIN 4109	EN 1111
EN 200	ISO 3822	Scottish Water Byelaws	UK Water Supply Regulations
Ü-Zeichen			

Certificates and sustainability				
DVGW_DW-6501DN0	WRAS_2011	LGA_29	WRAS_2010	DVGW_DW-6512DN0
LGA_29	IAPMO_4976 (			

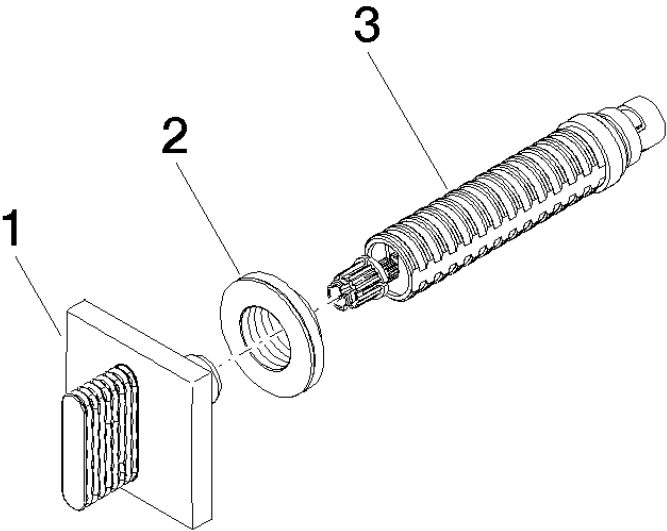

### Spare parts list

No.	Item Number	Name	Quantity used	Delivery time
1	90 20 70 053 01-06	handle	1.00	10
2	09 21 02 108 90	disc	1.00	60
3	90 90 03 143 00 90	top	1.00	2