





CL.1 Wall valve clockwise closing 1/2" - Brushed Dark Platinum

CL.1

36 627 705    Product version up to 10/14/2020

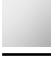

- with CASCADE structure
- rosette 60 x 60 mm
- without marking
- head part with cut-to-length spindle and sleeve
- WRAS

|   |                               |               |
|---|-------------------------------|---------------|
|  | Brushed Dark Platinum         | 36 627 705-99 |
|  | Chrome                        | 36 627 705-00 |
|  | Brushed Platinum              | 36 627 705-06 |
|  | Dark Chrome                   | 36 627 705-19 |
|  | Brushed Champagne (22kt Gold) | 36 627 705-46 |
|  | Champagne (22kt Gold)         | 36 627 705-47 |

Required miscellaneous

|   |                           |               |
|---|---------------------------|---------------|
| <b>Wall valve 1/2" -</b>  |                           | 35 607 970 90 |
|  | •max. recess depth 150 mm |               |
|   | •min. recess depth 105 mm |               |

36 627 705    Product version up to 10/14/2020

mm [inches]



| Codes & Standards |          |                        |                             |
|-------------------|----------|------------------------|-----------------------------|
| ASME A112.18.1    | cUPC     | DIN 4109               | EN 1111                     |
| EN 200            | ISO 3822 | Scottish Water Byelaws | UK Water Supply Regulations |
| Ü-Zeichen         |          |                        |                             |

| Certificates and sustainability |              |        |           |                 |
|---------------------------------|--------------|--------|-----------|-----------------|
| DVGW_DW-6501DN0                 | WRAS_2011    | LGA_29 | WRAS_2010 | DVGW_DW-6512DN0 |
| LGA_29                          | IAPMO_4976 ( |        |           |                 |

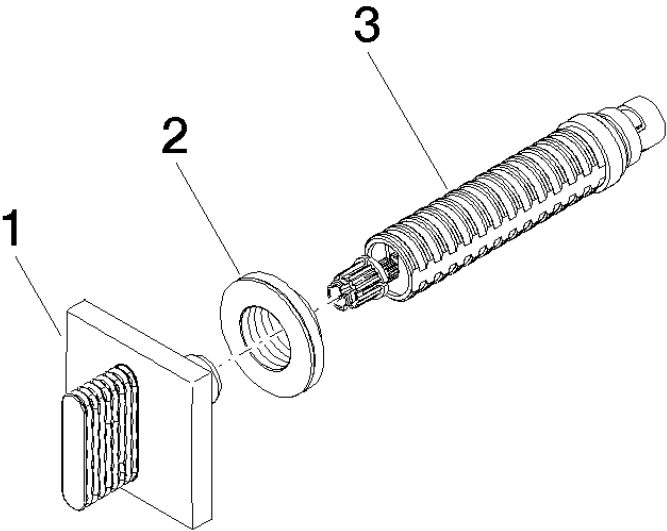

Spare parts list

| No. | Item Number        | Name   | Quantity used | Delivery time |
|-----|--------------------|--------|---------------|---------------|
| 2   | 09 21 02 108 90    | disc   | 1.00          | 60            |
| 1   | 90 20 70 053 01-99 | handle | 1.00          | 20            |
| 3   | 90 90 03 143 00 90 | top    | 1.00          | 2             |