

CYO Wall-mounted basin mixer without pop-up waste - Dark Chrome







CYO

36 712 811

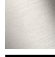

- 190mm projection
- fixed spout
- rectangular, air-enriched flow
- hole diameter valve 37 mm
- hole diameter spout 37 mm
- handle Ø 60mm
- max. flow 4.5 l/min
- lead-free
- This product can help a building meet the requirements of Green Building Rating Systems, e.g. LEED®, BREEAM®, DGNB
- WRAS

NOTE: The handle inserts must be ordered separately from the fittings!

	Dark Chrome	36 712 811-19
	Chrome	36 712 811-00
	Brushed Platinum	36 712 811-06
	Brushed Durabronze (23kt Gold)	36 712 811-28
	Platinum / Brushed Platinum	36 712 811-36
	Durabronze / Brushed Durabronze (23kt Gold)	36 712 811-38
	Brushed Dark Platinum	36 712 811-99

36 712 811

mm [inches]

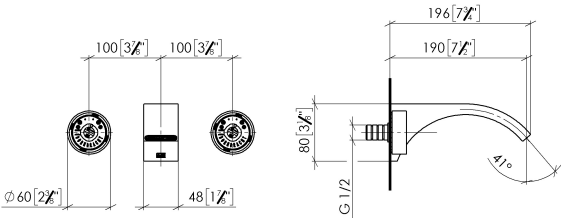

Flow rate chart

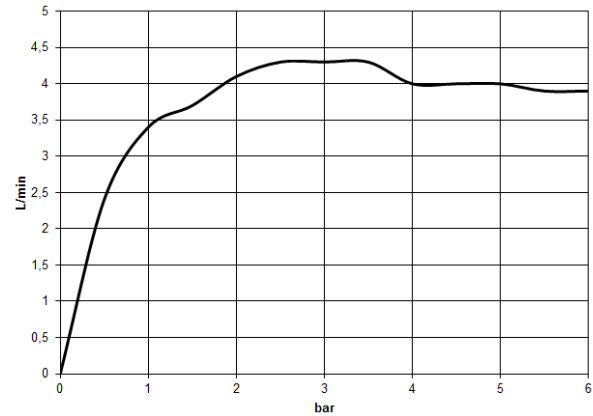

Codes & Standards

ASME A112.18.1	cUPC	NSF372	NSF61
----------------	------	--------	-------



CYO Wall-mounted basin mixer without pop-up waste - Dark Chrome

CYO

36 712 811

Certificates and sustainability

IAPMO_N-4976 IAPMO_6397 IAPMO_4976 (

36 712 811

Parts for other
finishes can be found
here: [Chrome](#)

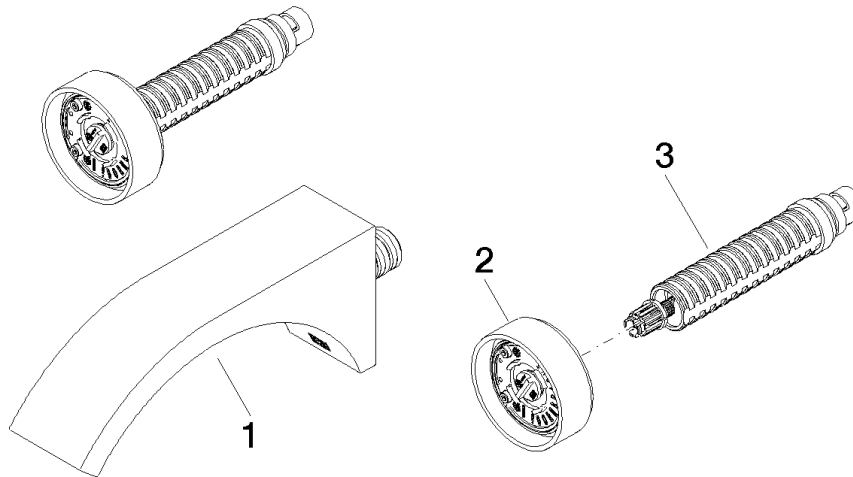

Spare parts list

No.	Item Number	Name	Quantity used	Delivery time
1	13 805 811-19	CYO Wall-mounted basin spout without pop-up waste - Dark Chrome	1.00	20
2	90 18 40 290 00-19	handle	1.00	20
3	90 90 03 171 01 90	top	1.00	2