









## META META SLIM Wall-mounted single-lever basin mixer without pop-up waste - Brushed Chrome

META

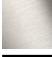
36 861 662 Product version up to 9/1/2021

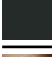

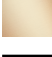
- 250mm projection
- fixed spout
- circular, air-enriched flow
- hole diameter spout 37 mm
- hole diameter single-lever mixer 57 mm
- rosette for spout Ø 55mm
- rosette for mixer Ø 78mm
- max. flow 5.7 l/min
- lead-free
- This product can help a building meet the requirements of Green Building Rating Systems, e.g. LEED®, BREEAM®, DGNB

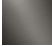
	Brushed Chrome	36 861 662-93
	Chrome	36 861 662-00
	Brushed Platinum	36 861 662-06
	Dark Chrome	36 861 662-19
	Light Gold	36 861 662-26
	Brushed Light Gold	36 861 662-27
	Matte Black	36 861 662-33
	Brushed Bronze	36 861 662-42
	Brushed Champagne (22kt Gold)	36 861 662-46
	Champagne (22kt Gold)	36 861 662-47
	Brushed Dark Platinum	36 861 662-99

# META META SLIM Wall-mounted single-lever basin mixer without pop-up waste - Brushed Chrome

META

36 861 662 Product version up to 9/1/2021  
mm [inches]

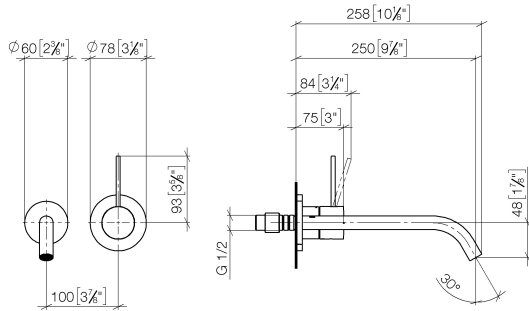

Flow rate chart



Trajectory diagram



## Codes & Standards

DIN 4109

EN 817

ISO 3822

Ü-Zeichen



## META META SLIM Wall-mounted single-lever basin mixer without pop-up waste - Brushed Chrome

---

META

36 861 662 Product version up to 9/1/2021

Certificates and sustainability

---

DVGW\_DW-  
6512DN0

LGA\_29

## META META SLIM Wall-mounted single-lever basin mixer without pop-up waste - Brushed Chrome

META

36 861 662 Product version up to 9/1/2021

Parts for other  
finishes can be found  
here: [Chrome](#)

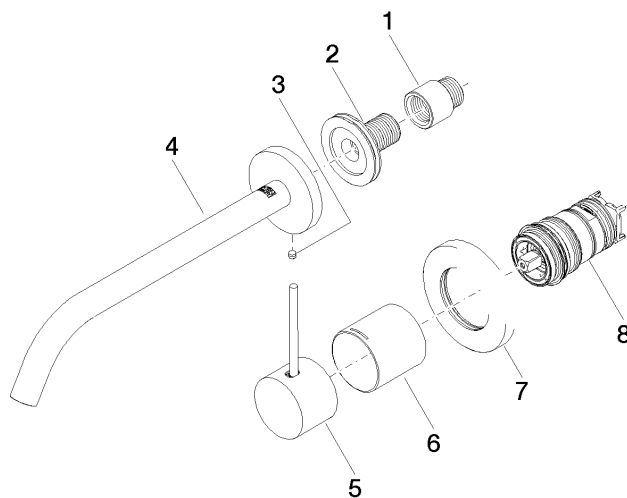

### Spare parts list

No.	Item Number	Name	Quantity used	Delivery time
3	09 31 11 112 90	pin	1.00	60
1	09 24 03 072 10 90	nipple	1.00	2
4	90 28 22 324 00-93	spout	1.00	20
8	90 15 05 044 02 90	cartridge	1.00	2
7	90 27 62 011 00-93	rosette	1.00	20
6	09 11 02 336-93	sleeve	1.00	20
5	90 20 66 022 00-93	handle	1.00	20
2	90 24 03 280 00 90	nipple	1.00	2