

Towel warmer , 6-fold , projection left , without control element - Matte Black
SERIES SPECIFIC

83 306 980
Product version from 4/1/2025



- gauge 120 mm
 - width 600mm
 - height 660 mm
 - rosette 60 x 60 mm
 - 63mm projection
 - Degree of protection IP 44, CE marking
 - Output per towel bar: 15 watts
 - Rated voltage: 220 - 240 V AC

Without control element

Activation must be handled by the customer

Note: Different conditioning.





This appliance is a stationary electric space heater and, in order to comply with the mandatory ecodesign requirements of Commission Regulation (EU) 2024/1103, must be equipped with at least one control with control function TW(f2).

Without control element

Activation must be handled by the customer

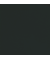
Note: Different conditioning.

This appliance is a stationary electric space heater and, in order to comply with the mandatory ecodesign requirements of Commission Regulation (EU) 2024/1103, must be equipped with at least one control with control function TW(f2).

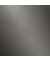
	Matte Black	83 306 980-33
	Chrome	83 306 980-00
	Dark Chrome	83 306 980-19
	Brushed Champagne (22kt Gold)	83 306 980-46
	Brushed Chrome	83 306 980-93
	Brushed Dark Platinum	83 306 980-99

Required miscellaneous



- Concealed wall installation box for 35 313 970 90 towel warmer , 6-fold , without control element -**

 - min. recess depth 70 mm
 - max. recess depth 105 mm

83 306 980 Product version from 4/1/2025

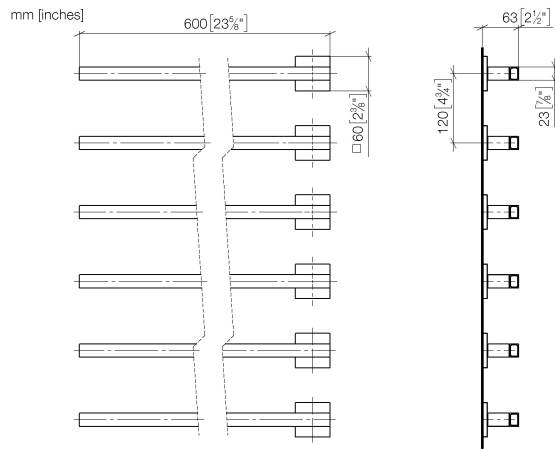

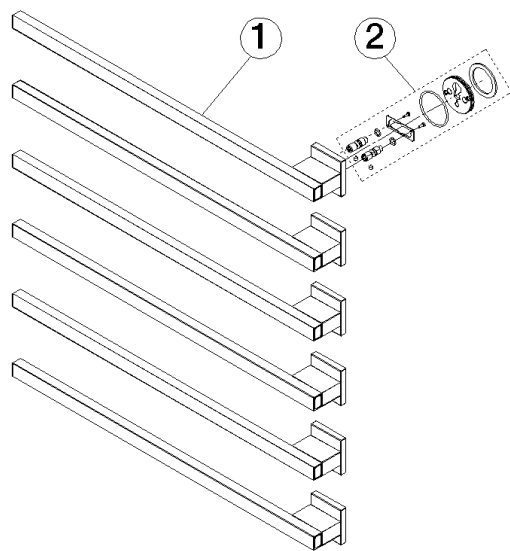

Spare parts list

No.	Item Number	Name	Quantity used	Delivery time
2	90 30 30 252 00 90	fixing set	1.00	30
1	90 17 98 561 00-33	holder	1.00	30