







CYO Three-hole basin mixer with pop-up waste - Platinum / Brushed Platinum

CYO

ST 010 108 2811



- 167mm projection
- fixed spout
- rectangular, air-enriched flow
- height of mixer 198 mm
- height up to aerator 133 mm
- hole diameter spout 35 mm
- hole diameter valve 32 mm
- handle Ø 60mm
- max. flow 4.5 l/min
- lead-free
- with hot / cold marking
- This product can help a building meet the requirements of Green Building Rating Systems, e.g. LEED®, BREEAM®, DGNB

	Platinum / Brushed Platinum	ST 010 108 2811-36
	Chrome	ST 010 108 2811-00
	Brushed Platinum	ST 010 108 2811-06
	Dark Chrome	ST 010 108 2811-19
	Brushed Durabass (23kt Gold)	ST 010 108 2811-28
	Durabass / Brushed Durabass (23kt Gold)	ST 010 108 2811-38
	Brushed Dark Platinum	ST 010 108 2811-99

Individual components of this set

You need the following components for this set



1x 11 283 811-06



1x 20 713 811-36



CYO Three-hole basin mixer with pop-up waste - Platinum / Brushed Platinum

CYO

ST 010 108 2811



- with hot / cold marking
- for three-hole basin mixers and five-hole bath mixers

	Brushed Platinum	11 283 811-0
	Chrome	11 283 811-0
	Platinum	11 283 811-0
	Durabrand (23kt Gold)	11 283 811-0
	Dark Chrome	11 283 811-1
	Brushed Durabrand (23kt Gold)	11 283 811-2
	Brushed Champagne (22kt Gold)	11 283 811-4
	Champagne (22kt Gold)	11 283 811-4
	Brushed Dark Platinum	11 283 811-9



CYO Three-hole basin mixer with pop-up waste - Platinum / Brushed Platinum

CYO

ST 010 108 2811

6
—
0
—
8
—
9
—
9
—
8
—
6
—
7
—
9
—

Product version from 7/1/2023

Parts for other
finishes can be found
here: [Chrome](#)

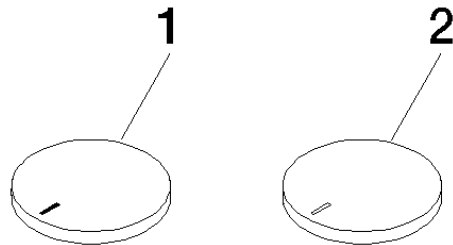



CYO Three-hole basin mixer with pop-up waste - Platinum / Brushed Platinum

CYO

ST 010 108 2811

Spare parts list

Product version from 7/1/2023

No.	Item Number	Name	Quantity used	Delivery time
	11 183 811-06	CYO Handle insert hot - Brushed Platinum	2	10

CYO Three-hole basin mixer with pop-up waste - Platinum / Brushed Platinum







CYO

ST 010 108 2811



- 167mm projection
- fixed spout
- rectangular, air-enriched flow
- height of mixer 198 mm
- height up to aerator 133 mm
- hole diameter spout 35 mm
- hole diameter valve 32 mm
- handle Ø 60mm
- max. flow 4.5 l/min
- lead-free
- This product can help a building meet the requirements of Green Building Rating Systems, e.g. LEED®, BREEAM®, DGNB
- WRAS 2111022

NOTE: The handle inserts must be ordered separately from the fittings!

	Platinum / Brushed Platinum	20 713 811-3
	Chrome	20 713 811-0
	Brushed Platinum	20 713 811-0
	Dark Chrome	20 713 811-1
	Brushed Durabronze (23kt Gold)	20 713 811-2
	Durabronze / Brushed Durabronze (23kt Gold)	20 713 811-3
	Brushed Dark Platinum	20 713 811-9



CYO Three-hole basin mixer with pop-up waste - Platinum / Brushed Platinum

CYO

ST 010 108 2811

6
—
0
—
6
—
9
—
8
—
8
—
9
—

ST 010 108 2811

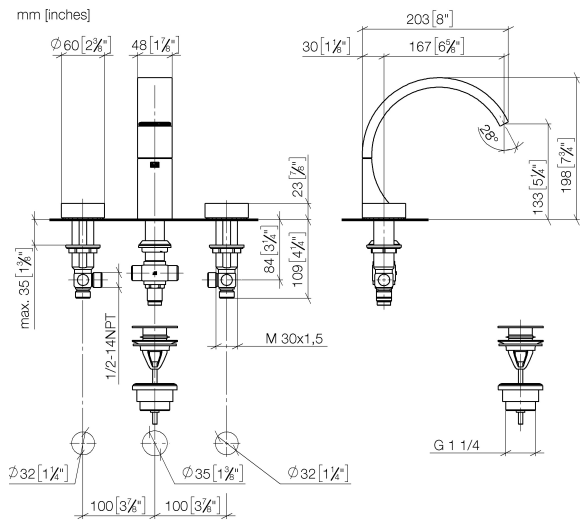

Flow rate chart

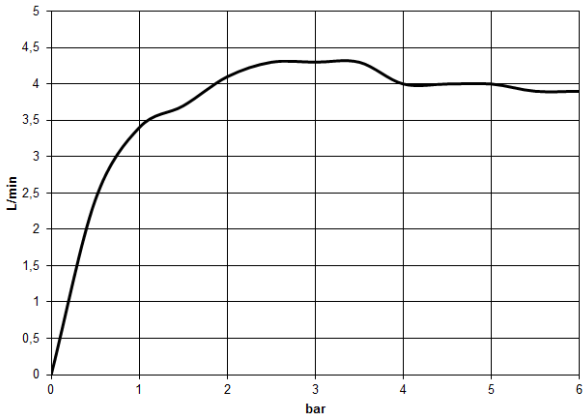

Certificates

WRAS_2111

LGA_38



CYO Three-hole basin mixer with pop-up waste - Platinum / Brushed Platinum

CYO

ST 010 108 2811

Codes & Standards

DIN 4109	ISO 3822	Scottish Water Byelaws	UK Water Supply Regulations
----------	----------	---------------------------	--------------------------------

Ü-Zeichen

Parts for other
finishes can be found
here: [Chrome](#)

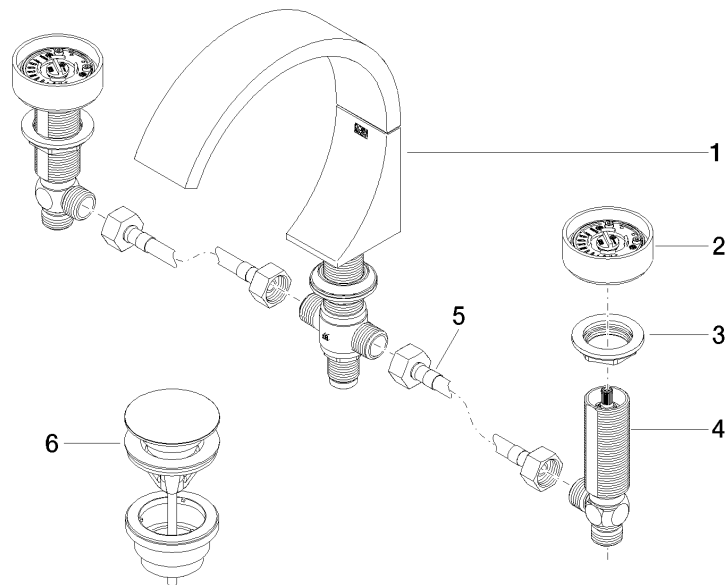



CYO Three-hole basin mixer with pop-up waste - Platinum / Brushed Platinum

CYO

ST 010 108 2811

Spare parts list

No.	Item Number	Name	Quantity used	Delivery time
	13 717 811-36	CYO Deck-mounted basin spout without pop-up waste - Platinum / Brushed Platinum	10	20