

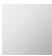







- 105mm projection
- fixed spout
- rectangular, air-enriched flow
- height of mixer 126 mm
- height up to aerator 66 mm
- hole diameter 35 mm
- 1/2" connection
- rosette Ø 50 mm
- max. flow 4.6 l/min
- lead-free

	Dark Chrome	17 500 671-19
	Chrome	17 500 671-00
	Brushed Platinum	17 500 671-06
	Brushed Light Gold	17 500 671-27
	Matte Black	17 500 671-33
	Brushed Chrome	17 500 671-93
	Brushed Dark Platinum	17 500 671-99

mm [inches]

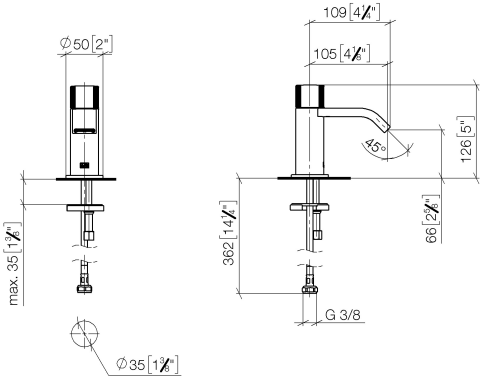

Flow rate chart

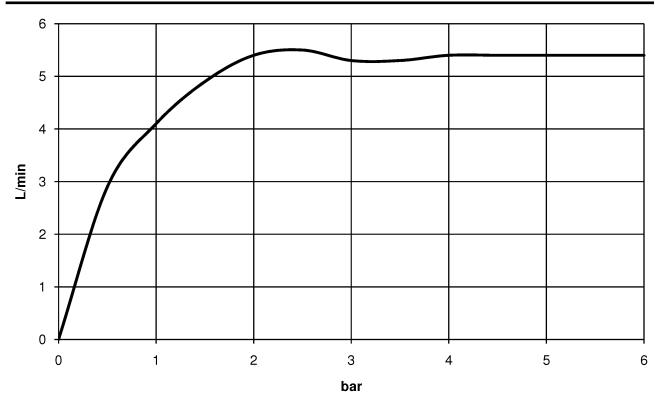

Codes & Standards

DIN 4109	ISO 3822	Scottish Water Byelaws	UK Water Supply Regulations
----------	----------	------------------------	-----------------------------

Ü-Zeichen



IMO Pillar tap cold water - Dark Chrome

IMO

17 500 671 Product version from 4/1/2024

Certificates and sustainability

LGA_38

WRAS_250502

Parts for other
finishes can be found
here: [Chrome](#)

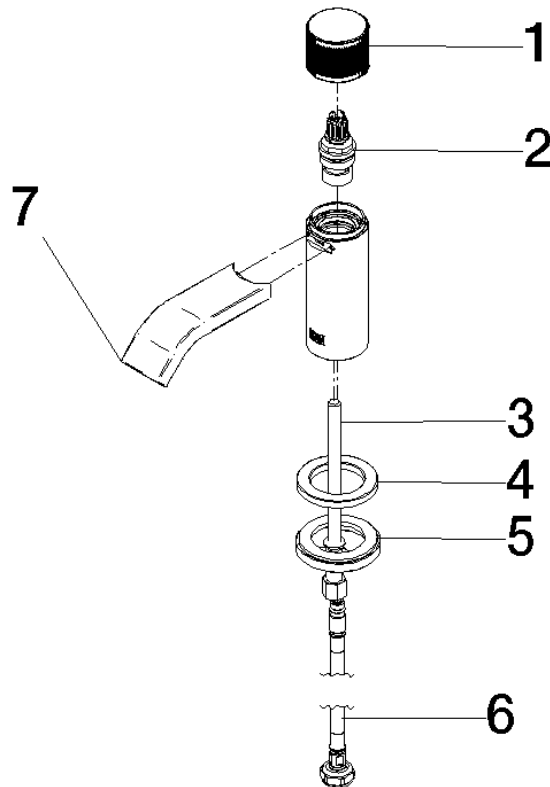

Spare parts list

No.	Item Number	Name	Quantity used	Delivery time
6	04 30 04 100 00 90	hose	1.00	2
7	90 28 22 402 00-19	spout	1.00	20
2	90 90 03 135 00 90	top	1.00	2
5	04 30 11 038 00 90	fixing set	1.00	2
1	09 20 66 012-19	handle	1.00	20
3	09 31 11 012 90	pin	1.00	2
4	09 27 66 006-19	rosette	1.00	20