

CYO Deck valve clockwise closing - Brushed Dark Platinum







CYO

20 000 811

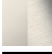

- hole diameter valve 32 mm
- without rosette
- handle Ø 60mm
- WRAS

NOTE: The handle inserts must be ordered separately from the fittings!

	Brushed Dark Platinum	20 000 811-99
	Chrome	20 000 811-00
	Brushed Platinum	20 000 811-06
	Dark Chrome	20 000 811-19
	Brushed Durabrand (23kt Gold)	20 000 811-28
	Platinum / Brushed Platinum	20 000 811-36
	Durabrand / Brushed Durabrand (23kt Gold)	20 000 811-38

20 000 811

mm [inches]

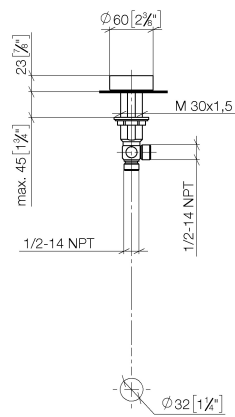

Codes & Standards

ASME A112.18.1	cUPC	DIN 4109	ISO 3822
NSF372	NSF61	Scottish Water Byelaws	UK Water Supply Regulations

Ü-Zeichen

Certificates and sustainability

LGA_38	IAPMO_N-4	IAPMO_4976	IAPMO_6	WRAS_2109
--------	-----------	------------	---------	-----------

20 000 811

Parts for other
finishes can be found
here: [Chrome](#)

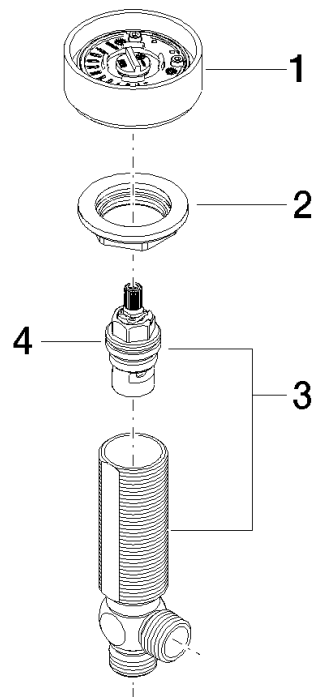

Spare parts list

No.	Item Number	Name	Quantity used	Delivery time
1	90 18 40 291 01-99	handle	1.00	20
2	04 30 11 038 68 90	fixing set	1.00	2
3	04 17 11 055 61 90	side panel	1.00	2
4	90 90 03 237 00 90	top	1.00	2