

Shower set - Soft Black



SERIES SPECIFIC

26 413 832

Product version from 1/1/2023

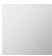
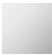

- spray head Ø 100mm
- Three or five settings: COMPACT RAIN, COMPACT SOFT FLOW, COMPACT AQUAPRESSURE FLOW, max. flow rate l/min (at 3 bar)
- Function from: l/min
- shower hose connector 1/2"
- Plastic hose, 1750 mm, with integrated anti-twist protection
- slide bar
- gauge 860 mm
- Pipe diameter 18 mm
- inherently safe from back flow
- WRAS

	Soft Black	26 413 832-69
	Chrome	26 413 832-00
	Chrome	26 413 832-00 0010
	Soft Black	26 413 832-69 0010

26 413 832 Product version from 1/1/2023

mm [inches]

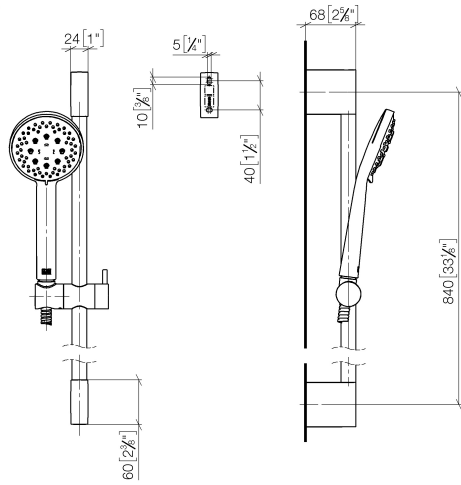

Flow rate chart

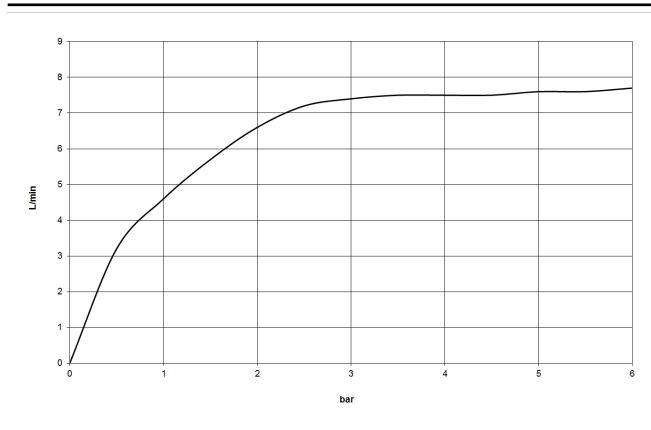

Codes & Standards

DIN 4109

ISO 3822

Scottish Water
Byelaws

UK Water Supply
Regulations

Ü-Zeichen



Shower set - Soft Black

SERIES SPECIFIC

26 413 832 Product version from 1/1/2023

Certificates and sustainability

WRAS_2212 LGA_29

26 413 832 Product version from 1/1/2023

Parts for other
finishes can be found
here: [Chrome](#)

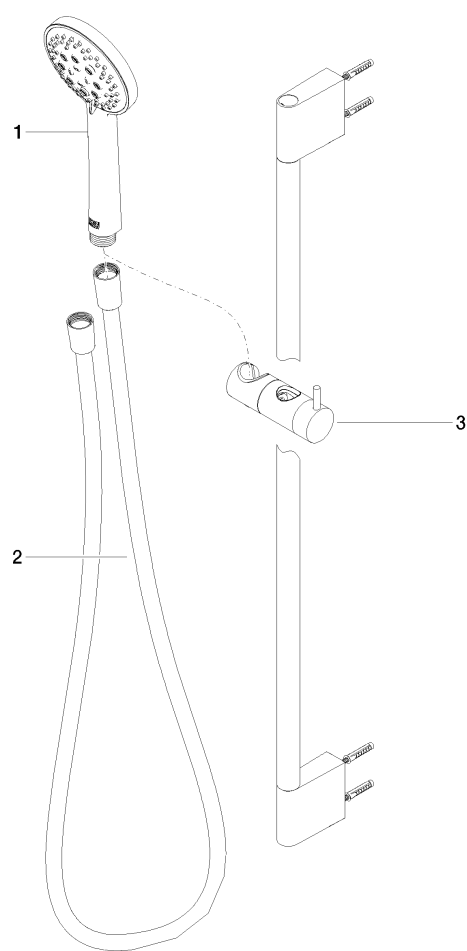

Spare parts list

No.	Item Number	Name	Quantity used	Delivery time
2	90 30 03 008 00-69	hose	1.00	2
1	90 12 11 183 00-69	shower	1.00	2
3	90 30 12 510 00-69	slider	1.00	2