

Rain shower for recessed ceiling installation 300 mm - Chrome

SERIES SPECIFIC

28 033 970 Product version from 5/1/2022

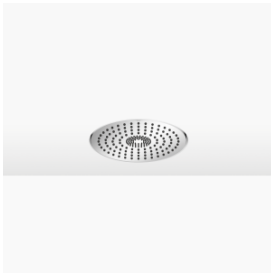

- rain shower Ø 300 mm
- PURE RAIN, max. flow rate 12 l/min (at 3 bar)
- PURIFY RAIN, max. flow rate 6 l/min (at 3 bar)
- with anti-scale system

Technical dimensions:

- min. recess depth 137 mm

Planning tips:

- For simultaneous control of the jet types, we recommend the xTool thermostat module
- Not suitable for use in a steam room.
- WRAS

| | | |
|---|--------------------------------|---------------|
|  | Chrome | 28 033 970-00 |
|  | Brushed Platinum | 28 033 970-06 |
|  | Platinum | 28 033 970-08 |
|  | Dark Chrome | 28 033 970-19 |
|  | Light Gold | 28 033 970-26 |
|  | Brushed Light Gold | 28 033 970-27 |
|  | Brushed Durabronze (23kt Gold) | 28 033 970-28 |
|  | Matte Black | 28 033 970-33 |
|  | Brushed Bronze | 28 033 970-42 |
|  | Brushed Champagne (22kt Gold) | 28 033 970-46 |
|  | Champagne (22kt Gold) | 28 033 970-47 |
|  | Brushed Chrome | 28 033 970-93 |
|  | Brushed Dark Platinum | 28 033 970-99 |

Required miscellaneous



Concealed ceiling installation box 35 033 970 90 for recessed ceiling installation -

- recess depth 137mm
- 2x female thread 1/2" outlet
- concealed rough parts
- flush-mounted installation box Ø 360 mm RAL 9003 signal white

28 033 970 Product version from 5/1/2022

mm [inches]

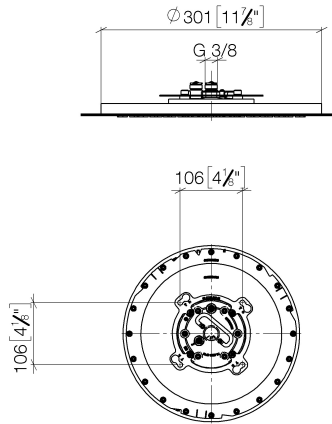

Flow rate chart

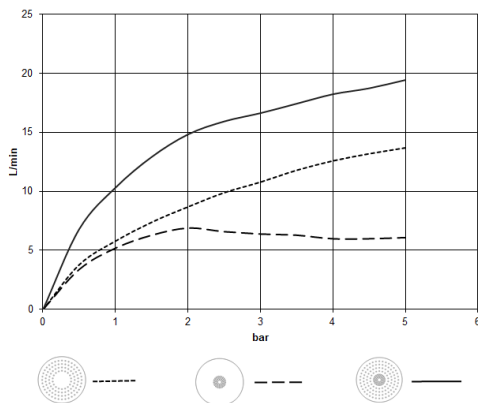

Codes & Standards

DIN 4109

ISO 3822

Scottish Water
Byelaws

UK Water Supply
Regulations

Ü-Zeichen



Rain shower for recessed ceiling installation 300 mm - Chrome

SERIES SPECIFIC

28 033 970 Product version from 5/1/2022

Certificates and sustainability

LGA_38

WRAS_240502

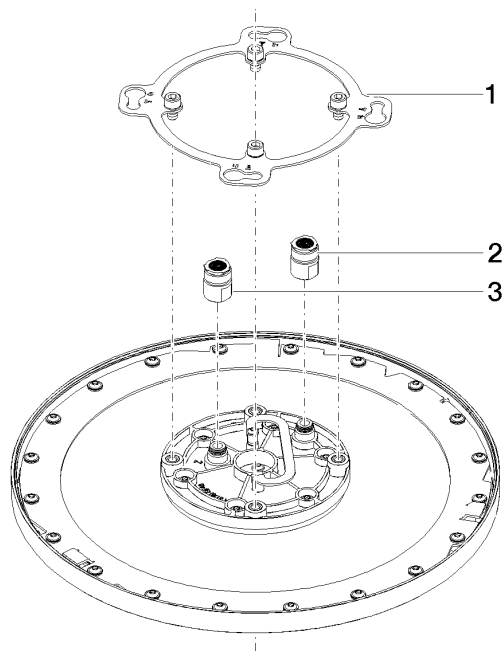

Spare parts list

| No. | Item Number | Name | Quantity used | Delivery time |
|-----|--------------------|------------|---------------|---------------|
| 1 | 90 17 20 262 00 90 | flange | 1.00 | 2 |
| 2 | 90 24 03 309 01 90 | connection | 1.00 | 2 |
| 3 | 90 24 03 309 00 90 | connection | 1.00 | 2 |