

Rain shower for surface-mounted ceiling installation with light 300 x 240 mm - **SERIES SPECIFIC**
Brushed Dark Platinum

28 042 980 Product version from 5/1/2022

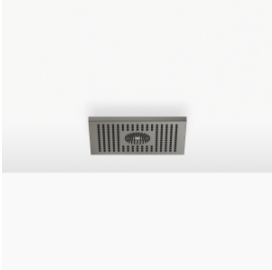

- rain shower 300 x 240mm
 - PURE RAIN, max. flow rate 12 l/min (at 3 bar)
 - PURIFY RAIN, max. flow rate 6 l/min (at 3 bar)
 - with anti-scale system
- Technical dimensions:**
- Distance to ceiling from bottom edge of shower 40 mm
- Ceiling module power supply**
- 350mA (CC)
- Electric:**
- Spot lighting**
- Technology: LED, not dimmable
 - LED colour temperature approx. 3000 K
 - Provided by customer: Light switch
 - Contains energy efficiency class bulbs
 - Bulbs protected against splashing water
- Environment**
- Planning tips:**
- Not suitable for outdoor use.
 - Not suitable for use in a steam room.
 - Not suitable for use in chlorinated or salty environments.
 - Comply with the protection zone regulations as defined in DIN VDE 0100, Part 701 (IEC 60364-7-701).
 - WRAS

	Brushed Dark Platinum	28 042 980-99
	Chrome	28 042 980-00
	Brushed Platinum	28 042 980-06
	Platinum	28 042 980-08
	Brushed Durabronze (23kt Gold)	28 042 980-28
	Matte Black	28 042 980-33
	Brushed Champagne (22kt Gold)	28 042 980-46
	Champagne (22kt Gold)	28 042 980-47
	Brushed Chrome	28 042 980-93

Required miscellaneous



- Concealed ceiling installation box 35 042 970 90 for surface-mounted ceiling installation with light -**
- min. recess depth 90 mm
 - max. recess depth 115 mm
 - 2x female thread 1/2" connections
 - Input 100-240V AC 50-60Hz
 - concealed rough parts
 - Output 350 mA SELV / Class 2
 - Provided by customer: Light switch

Rain shower for surface-mounted ceiling installation with light 300 x 240 mm - SERIES SPECIFIC Brushed Dark Platinum

28 042 980 Product version from 5/1/2022

mm [inches]

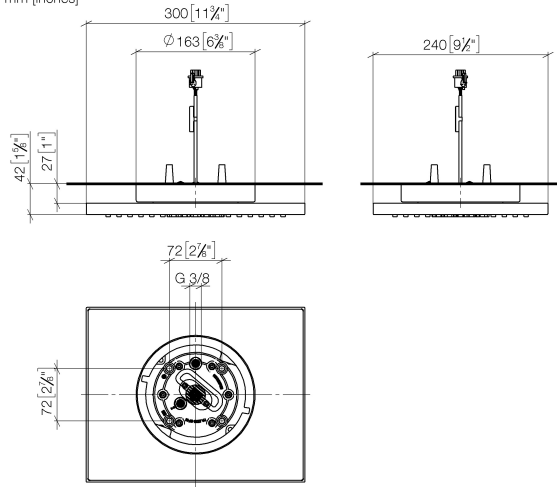

Flow rate chart



Codes & Standards

DIN 4109

ISO 3822

Scottish Water
Byelaws

UK Water Supply
Regulations

Ü-Zeichen



Rain shower for surface-mounted ceiling installation with light 300 x 240 mm - SERIES SPECIFIC Brushed Dark Platinum

28 042 980 Product version from 5/1/2022

Certificates and sustainability

LGA_38

WRAS_240502

Rain shower for surface-mounted ceiling installation with light 300 x 240 mm - SERIES SPECIFIC Brushed Dark Platinum

28 042 980 Product version from 5/1/2022

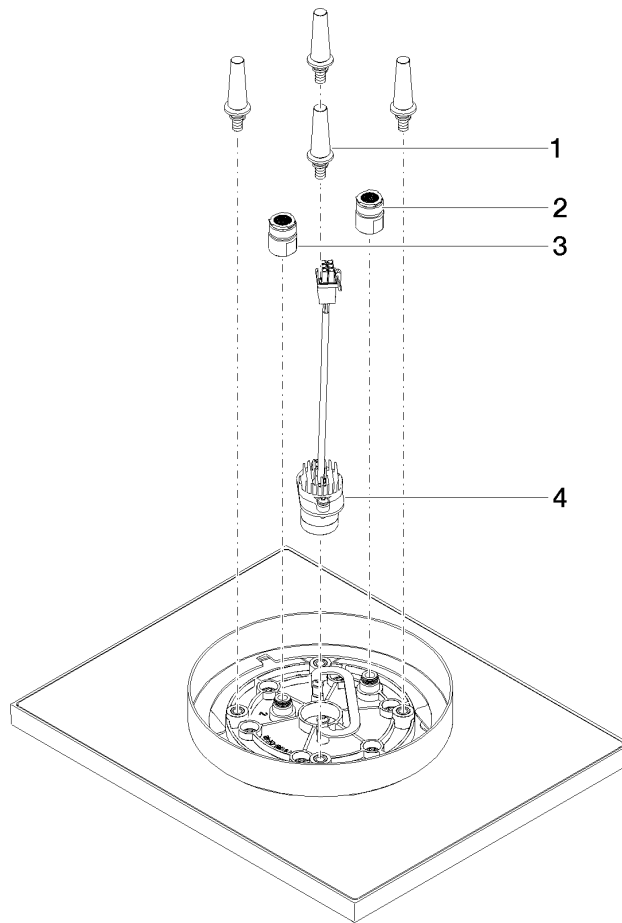

Spare parts list

No.	Item Number	Name	Quantity used	Delivery time
3	90 24 03 309 00 90	connection	1.00	2
2	90 24 03 309 01 90	connection	1.00	2
1	90 17 20 263 00 90	fixing set	1.00	2
4	90 10 01 225 00 90	electronic accessories	1.00	2