

Rain shower with ceiling fixing FlowReduce 300 mm - Brushed Champagne (22kt Gold)
SERIES SPECIFIC

28 688 970
Product version from 4/1/2024



- rain shower Ø 300 mm
- PURE RAIN, max. flow rate 9 l/min (at 3 bar)
- Function from: 7 l/min
- rosette Ø 60 mm optional
- 1/2" connection
- with anti-scale system
- quick clearing
- This product can help a building meet the requirements of Green Building Rating Systems, e.g. LEED®, BREEAM®, DGNB

	Brushed Champagne (22kt Gold)	28 688 970-46
	Chrome	28 688 970-00
	Brushed Platinum	28 688 970-06
	Platinum	28 688 970-08
	Dark Chrome	28 688 970-19
	Light Gold	28 688 970-26
	Brushed Light Gold	28 688 970-27
	Brushed Durabrass (23kt Gold)	28 688 970-28
	Matte Black	28 688 970-33
	Brushed Bronze	28 688 970-42
	Champagne (22kt Gold)	28 688 970-47
	Brushed Chrome	28 688 970-93
	Brushed Dark Platinum	28 688 970-99

Rain shower with ceiling fixing FlowReduce 300 mm - Brushed Champagne  
(22kt Gold)

SERIES SPECIFIC

28 688 970

Product version from 4/1/2024

mm [inches]

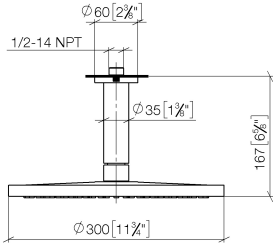

Flow rate chart



Codes & Standards

DIN 4109

ISO 3822

Ü-Zeichen



## Rain shower with ceiling fixing FlowReduce 300 mm - Brushed Champagne (22kt Gold)

SERIES SPECIFIC

---

28 688 970 Product version from 4/1/2024

Certificates and sustainability

---

LGA\_29

Rain shower with ceiling fixing FlowReduce 300 mm - Brushed Champagne  
(22kt Gold)

SERIES SPECIFIC

28 688 970    Product version from 4/1/2024  
Parts for other  
finishes can be found  
here: [Chrome](#)

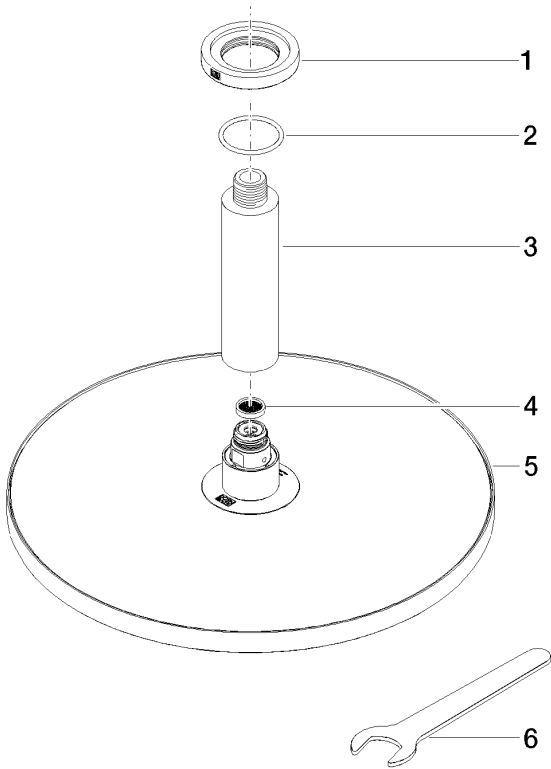

Spare parts list

No.	Item Number	Name	Quantity used	Delivery time
2	09 14 10 141 90	seal	1.00	2
1	09 27 22 040-46	rosette	1.00	30
4	09 23 01 075 90	insert	1.00	2
6	90 30 09 069 00 90	key	1.00	2
5	90 12 05 091 20-46	shower	1.00	30
3	09 11 03 080-46	connection	1.00	30