

## Rain shower with ceiling fixing 300 x 240 mm - Champagne (22kt Gold)

SERIES SPECIFIC

28 775 980 Product version from 3/13/2017



- rain shower 300 x 240mm
- PURE RAIN, max. flow rate 20 l/min (at 3 bar)
- Function from: 12 l/min
- distance between ceiling and lower edge of the shower 165mm
- rosette 60 x 60, as required
- 1/2" connection
- with anti-scale system
- quick clearing
- WRAS

Product change as of 1st April 2024: max. flow 20l/min

	Champagne (22kt Gold)	28 775 980-47
	Chrome	28 775 980-00
	Brushed Platinum	28 775 980-06
	Platinum	28 775 980-08
	Dark Chrome	28 775 980-19
	Brushed Light Gold	28 775 980-27
	Brushed Durabrass (23kt Gold)	28 775 980-28
	Matte Black	28 775 980-33
	Brushed Champagne (22kt Gold)	28 775 980-46
	Brushed Chrome	28 775 980-93
	Brushed Dark Platinum	28 775 980-99

### Recommended miscellaneous

#### Concealed wall elbow -

35 085 970 90



- max. recess depth 163 mm
- min. recess depth 90 mm

mm [inches]

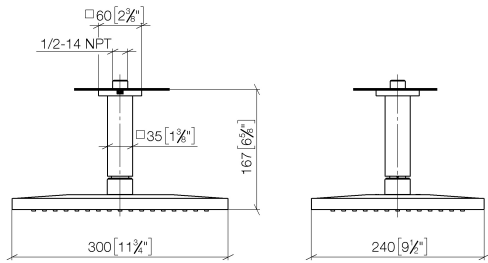

### Flow rate chart

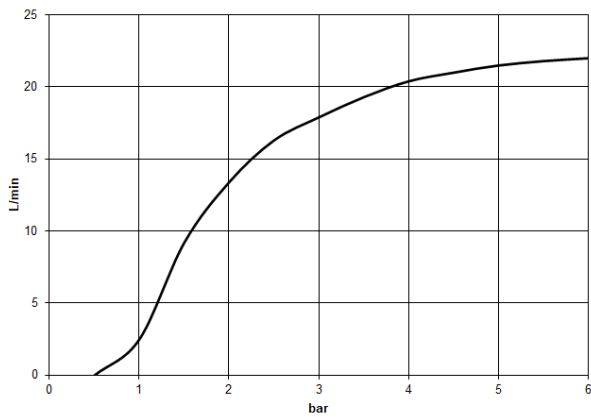

### Codes & Standards

DIN 4109	ISO 3822	Scottish Water Byelaws	UK Water Supply Regulations
----------	----------	------------------------	-----------------------------

### Ü-Zeichen



Rain shower with ceiling fixing 300 x 240 mm - Champagne (22kt Gold)

SERIES SPECIFIC

---

28 775 980    Product version from 3/13/2017

Certificates and sustainability

---

LGA\_29

WRAS\_2212

LGA\_38

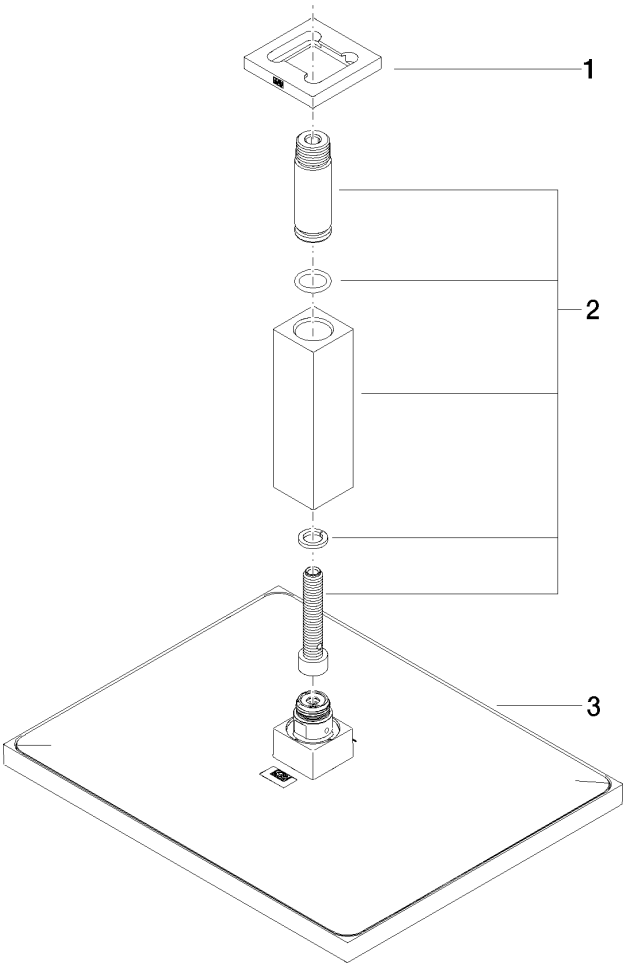

**Spare parts list**

No.	Item Number	Name	Quantity used	Delivery time
1	09 27 98 017-47	rosette	1.00	30
2	90 11 10 092 00-47	connection	1.00	30
3	04 12 05 063 00-47	shower	1.00	30