

**Rain shower with ceiling fixing 300 x 240 mm - Champagne (22kt Gold)**

IMO

28 775 980



Fits: IMO, MEM, CL.1

- rain shower 300 x 240mm
- PURE RAIN, max. flow rate 20 l/min (at 3 bar)
- Function from: 12 l/min
- distance between ceiling and lower edge of the shower 165mm
- rosette 60 x 60, as required
- 1/2" connection
- with anti-scale system
- quick clearing
- WRAS 1707033

Product change as of 1st April 2024: max. flow 20l/min

|  |                                |               |
|--|--------------------------------|---------------|
|  | Champagne (22kt Gold)          | 28 775 980-47 |
|  | Chrome                         | 28 775 980-00 |
|  | Brushed Platinum               | 28 775 980-06 |
|  | Platinum                       | 28 775 980-08 |
|  | Dark Chrome                    | 28 775 980-19 |
|  | Brushed Light Gold             | 28 775 980-27 |
|  | Brushed Durabronze (23kt Gold) | 28 775 980-28 |
|  | Matte Black                    | 28 775 980-33 |
|  | Brushed Champagne (22kt Gold)  | 28 775 980-46 |
|  | Brushed Chrome                 | 28 775 980-93 |
|  | Brushed Dark Platinum          | 28 775 980-99 |

**Recommended miscellaneous**

- Concealed wall elbow -** 35 085 970 90
- max. recess depth 163 mm
  - min. recess depth 90 mm



28 775 980

mm [inches]



Flow rate chart

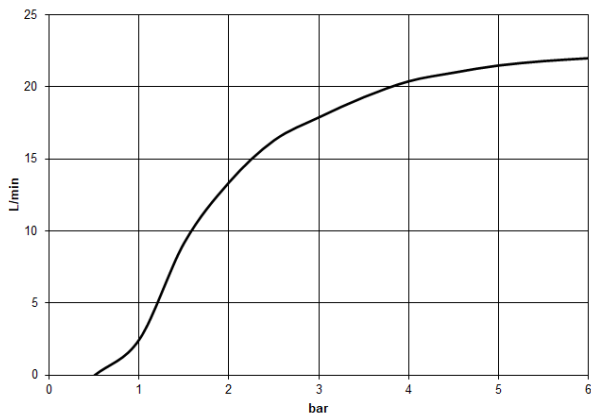

Certificates

LGA\_29232.      WRAS\_2212012.      LGA\_38662.

28 775 980

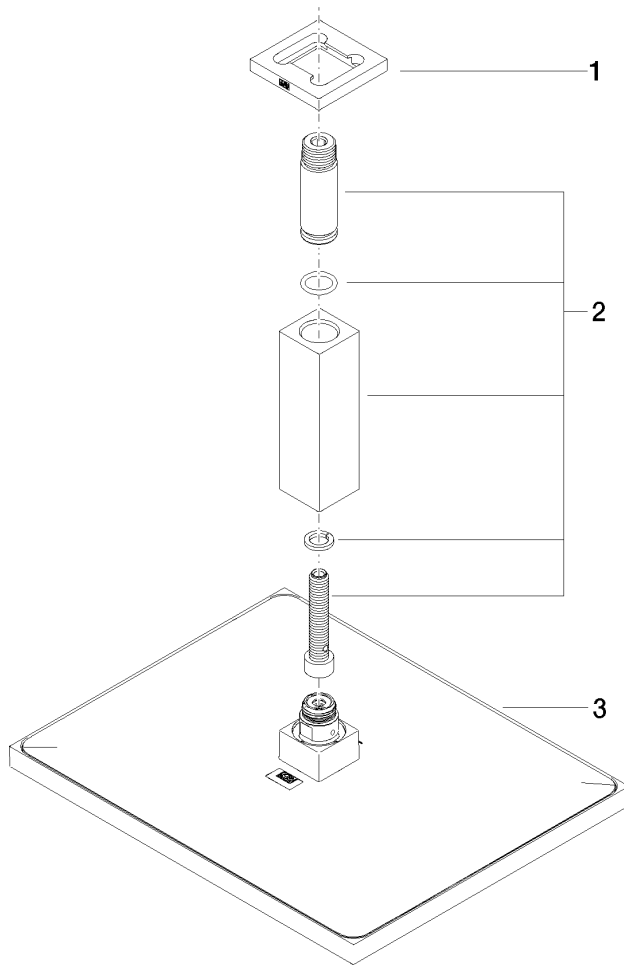

**Spare parts list**

| No. | Item Number        | Name       | Quantity used | Delivery time |
|-----|--------------------|------------|---------------|---------------|
| 1   | 09 27 98 017-47    | rosette    | 1             | 30            |
| 2   | 90 11 10 092 00-47 | connection | 1             | 30            |
| 3   | 04 12 05 063 00-47 | shower     | 1             | 30            |