











## VAIA Two-way diverter for bath rim or tile edge installation - Champagne (22kt Gold)

VAIA

29 140 809 Product version from 3/13/2017



- automatic bath/shower diverter
- hole diameter 30 mm
- rosette Ø 60 mm
- 1/2" connection
- max. flow 64.9 l/min at 3 bar flow pressure
- WRAS

	Champagne (22kt Gold)	29 140 809-47
	Chrome	29 140 809-00
	Brushed Platinum	29 140 809-06
	Platinum	29 140 809-08
	Dark Chrome	29 140 809-19
	Brushed Durabronze (23kt Gold)	29 140 809-28
	Brushed Dark Brass	29 140 809-39
	Brushed Bronze	29 140 809-42
	Brushed Champagne (22kt Gold)	29 140 809-46
	Brushed Dark Platinum	29 140 809-99

## VAIA Two-way diverter for bath rim or tile edge installation - Champagne (22kt Gold)

VAIA

29 140 809 Product version from 3/13/2017  
mm [inches]

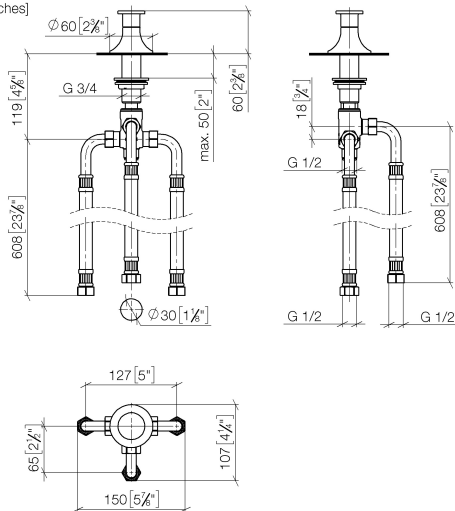

Flow rate chart



### Codes & Standards

DIN 4109

ISO 3822

Ü-Zeichen



## VAIA Two-way diverter for bath rim or tile edge installation - Champagne (22kt Gold)

VAIA

---

29 140 809 Product version from 3/13/2017

Certificates and sustainability

---

LGA\_29

## VAIA Two-way diverter for bath rim or tile edge installation - Champagne (22kt Gold)

VAIA

29 140 809 Product version from 3/13/2017

Parts for other  
finishes can be found  
here: [Chrome](#)

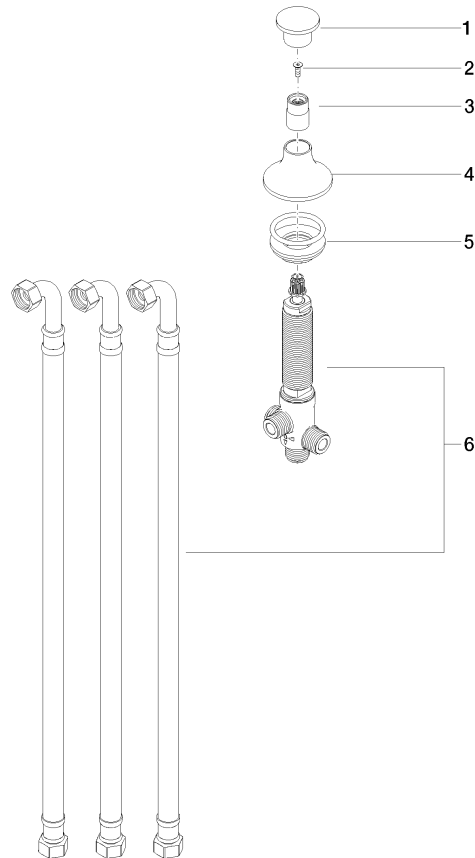

### Spare parts list

No.	Item Number	Name	Quantity used	Delivery time
6	90 17 09 051 00 90	diverter	1.00	2
3	09 18 40 214-47	sleeve	1.00	30
1	09 20 80 016-47	handle	1.00	30
5	04 23 10 004 03 90	fixing set	1.00	2
2	90 30 30 014 00 90	screw	1.00	2
4	09 27 80 015-47	rosette	1.00	30