



33 520 626



- 156mm projection
- pivotable spout 360°
- circular, air-enriched flow
- height of mixer 302 mm
- height up to aerator 191 mm
- hole diameter 35 mm
- 2x screw-in M 10 x 1 pressure hose, leak-tested
- max. flow 7 l/min
- lead-free
- WRAS

	Matte Black	33 520 626-33
	Chrome	33 520 626-00
	Brushed Chrome	33 520 626-93

33 520 626

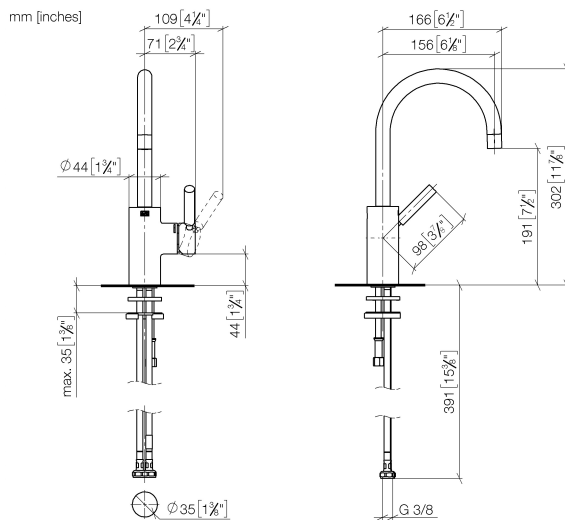

Flow rate chart



Codes & Standards

DIN 4109

ISO 3822

Scottish Water
Byelaws

UK Water Supply
Regulations

Ü-Zeichen



EDITION PRO Single-lever basin mixer without pop-up waste - Matte Black

EDITION PRO

33 520 626

Certificates and sustainability

LGA_19

WRAS_2201

33 520 626

Parts for other
finishes can be found
here: [Chrome](#)

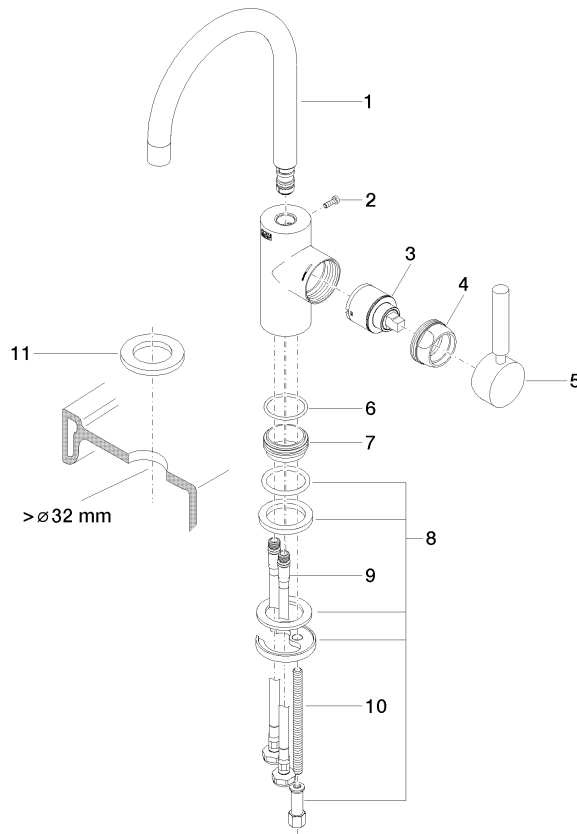

Spare parts list

No.	Item Number	Name	Quantity used	Delivery time
10	09 31 11 012 90	pin	1.00	2
6	09 14 10 119 90	seal	1.00	2
5	90 20 88 046 00-33	handle	1.00	30
1	90 28 22 237 00-33	spout	1.00	30
4	09 24 04 107-33	nut	1.00	30
11	12 730 970-33	Rosette for tap hole cover - Matte Black	1.00	30
2	09 30 30 080 90	screw	1.00	2
7	09 28 10 109-07	ring	1.00	30
9	04 30 04 104 00 90	hose	2.00	2
8	04 30 11 085 88 90	fixing set	1.00	2
3	90 15 05 045 00 90	cartridge	1.00	2