

VAIA Single-lever mixer - Champagne (22kt Gold)

VAIA

33 816 809    Product version from 7/1/2023



- 241mm projection
- pivotable spout 360°
- air-enriched flow
- max. flow 7 l/min at 3 bar flow pressure
- lead-free
- This product can help a building meet the requirements of Green Building Rating Systems, e.g. LEED®, BREEAM®, DGNB
- WRAS

|   |                               |               |
|---|-------------------------------|---------------|
|    | Champagne (22kt Gold)         | 33 816 809-47 |
|    | Chrome                        | 33 816 809-00 |
|    | Brushed Platinum              | 33 816 809-06 |
|    | Platinum                      | 33 816 809-08 |
|    | Durabrass (23kt Gold)         | 33 816 809-09 |
|    | Dark Chrome                   | 33 816 809-19 |
|    | Brushed Durabrass (23kt Gold) | 33 816 809-28 |
|    | Matte Black                   | 33 816 809-33 |
|    | Brushed Bronze                | 33 816 809-42 |
|   | Brushed Champagne (22kt Gold) | 33 816 809-46 |
|  | Brushed Chrome                | 33 816 809-93 |
|  | Brushed Dark Platinum         | 33 816 809-99 |

Recommended miscellaneous

VAIA Dispenser with rosette - Champagne (22kt Gold)

82 434 809-47



33 816 809 Product version from 7/1/2023



Flow rate chart

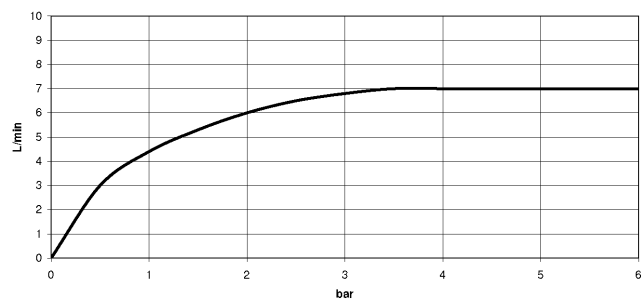

## Codes & Standards

DIN 4109

ISO 3822

Scottish Water  
Byelaws

UK Water Supply  
Regulations

Ü-Zeichen



## VAIA Single-lever mixer - Champagne (22kt Gold)

VAIA

33 816 809 Product version from 7/1/2023

Certificates and sustainability

LGA\_29

WRAS\_240602

33 816 809 Product version from 7/1/2023

Parts for other  
finishes can be found  
here: [Chrome](#)

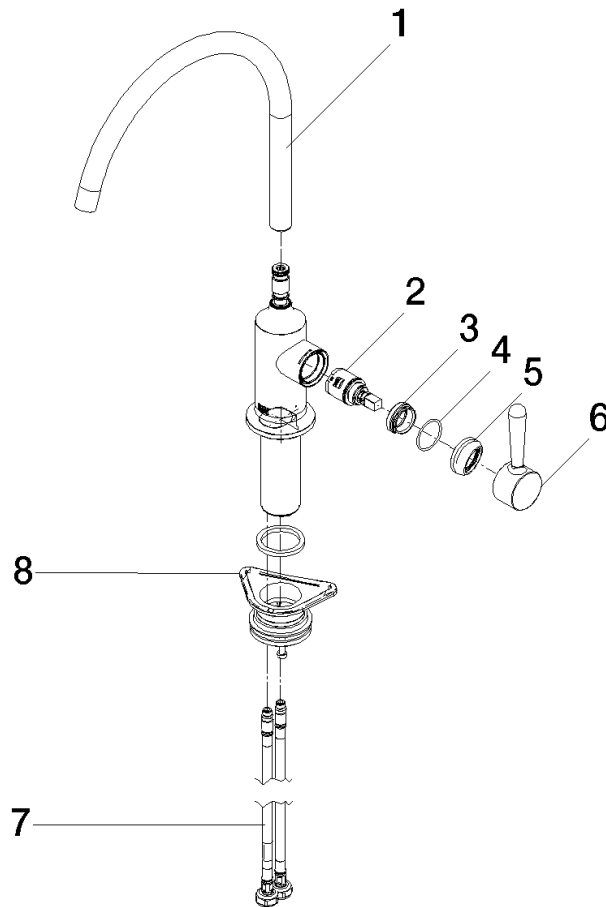

## Spare parts list

| No. | Item Number          | Name       | Quantity used | Delivery time |
|-----|----------------------|------------|---------------|---------------|
|     | 2 90 15 05 042 00 90 | cartridge  | 1.00          | 2             |
|     | 5 90 28 30 052 00-47 | cover      | 1.00          | 30            |
|     | 7 04 30 04 100 00 90 | hose       | 2.00          | 2             |
|     | 3 09 24 04 266 90    | nut        | 1.00          | 2             |
|     | 4 09 14 10 091 90    | seal       | 1.00          | 2             |
|     | 8 04 23 10 044 08 90 | fixing set | 1.00          | 2             |
|     | 6 90 20 80 050 00-47 | handle     | 1.00          | 30            |
|     | 1 90 28 22 396 00-47 | spout      | 1.00          | 30            |