







MEM Concealed two-way diverter - Brushed Durabrand (23kt Gold)
MEM

36 200 782
Product version from 4/1/2022

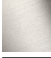
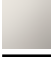

- rotary diverter
- rosette 60 x 60 mm
- WRAS

	Brushed Durabrand (23kt Gold)	36 200 782-28
	Chrome	36 200 782-00
	Brushed Platinum	36 200 782-06
	Platinum	36 200 782-08
	Dark Chrome	36 200 782-19
	Brushed Champagne (22kt Gold)	36 200 782-46
	Champagne (22kt Gold)	36 200 782-47
	Brushed Dark Platinum	36 200 782-99

Required miscellaneous



- Concealed two-way diverter -

35 202 970 90
- max. recess depth 160 mm
  - min. recess depth 115 mm

36 200 782 Product version from 4/1/2022

mm [inches]

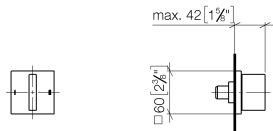

Flow rate chart



### Codes & Standards

DIN 4109	ISO 3822	Scottish Water Byelaws	UK Water Supply Regulations
----------	----------	---------------------------	--------------------------------

Ü-Zeichen



## MEM Concealed two-way diverter - Brushed Durabrass (23kt Gold)

MEM

36 200 782 Product version from 4/1/2022

Certificates and sustainability

LGA\_38

WRAS\_2307

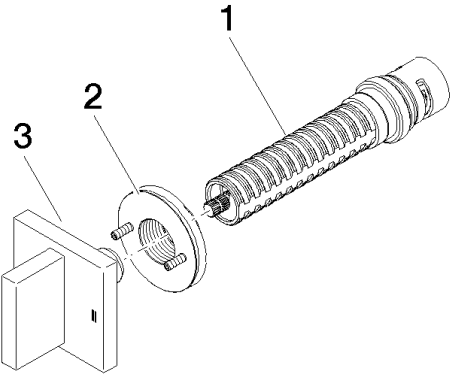

Spare parts list

No.	Item Number	Name	Quantity used	Delivery time
3	90 20 78 002 08-28	handle	1.00	20
2	90 21 02 181 00 90	disc	1.00	2
1	90 90 03 304 10 90	diverter	1.00	2