

MADISON xTOOL Concealed thermostat without volume control 1/2" - Brushed Platinum







MADISON

36 501 977

Product version up to 2/2/2021



- cover plate Ø 124 mm
- temperature control handle with safety limit stop at 38°C
- thermostat cartridge
- WRAS

	Brushed Platinum	36 501 977-06
	Chrome	36 501 977-00
	Platinum	36 501 977-08
	Durabrass (23kt Gold)	36 501 977-09
	Brushed Durabrass (23kt Gold)	36 501 977-28
	Brushed Dark Brass	36 501 977-39
	Brushed Dark Platinum	36 501 977-99

Required miscellaneous



xTOOL Concealed thermostat module without volume control -

35 503 970 90

- max. recess depth 110 mm
- min. recess depth 85 mm

Recommended miscellaneous



xGRID Attachment set for integrating in the dry wall construction -

12 340 970 90

Required miscellaneous



xGRID Installation track 555 mm -

12 360 970 90

# MADISON xTOOL Concealed thermostat without volume control 1/2" - Brushed Platinum

MADISON

36 501 977 Product version up to 2/2/2021  
mm [inches]

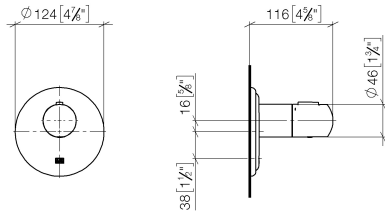

## Flow rate chart



## Codes & Standards

DIN 4109

EN 1111

ISO 3822

Scottish Water  
Byelaws

UK Water Supply  
Regulations

Ü-Zeichen



MADISON xTOOL Concealed thermostat without volume control 1/2" - Brushed  
Platinum

MADISON

36 501 977    Product version up to 2/2/2021

Certificates and sustainability

WRAS_2011	DVGW_DW- 6512DN0	LGA_29	LGA_29
-----------	---------------------	--------	--------

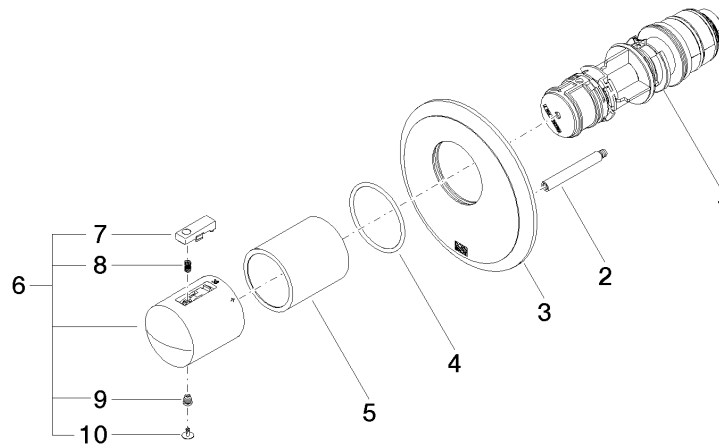

## Spare parts list

No.	Item Number	Name	Quantity used	Delivery time
3	09 11 02 391-06	plate	1.00	10
8	90 16 02 027 00 90	spring	1.00	2
6	90 17 33 005 01-06	handle	1.00	10
10	90 31 20 049 00-13	plug	1.00	30
5	90 21 02 112 00-06	sleeve	1.00	10
4	90 14 10 049 00 90	seal	1.00	2
9	90 30 30 136 00 90	screw	1.00	2
2	90 31 09 095 00 90	bar	1.00	2
7	90 21 33 011 00-13	handle	1.00	2
1	90 15 02 065 00 90	cartridge	1.00	2