

META Wall valve clockwise closing 1/2" - Brushed Bronze

META

36 607 661    Product version from 7/1/2023

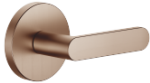

- rosette Ø 60 mm
- head part with cut-to-length spindle and sleeve
- WRAS

	Brushed Bronze	36 607 661-42
	Chrome	36 607 661-00
	Brushed Platinum	36 607 661-06
	Dark Chrome	36 607 661-19
	Light Gold	36 607 661-26
	Brushed Light Gold	36 607 661-27
	Matte Black	36 607 661-33
	Brushed Champagne (22kt Gold)	36 607 661-46
	Champagne (22kt Gold)	36 607 661-47
	Brushed Chrome	36 607 661-93
	Brushed Dark Platinum	36 607 661-99

Required miscellaneous

	<b>Wall valve 1/2" -</b> •min. recess depth 85 mm •max. recess depth 145 mm	35 607 970 90
---	---	---------------

Required miscellaneous

	<b>Wall valve 1/2" -</b> •min. recess depth 85 mm •max. recess depth 145 mm	35 607 970 90
---	---	---------------



META Wall valve clockwise closing 1/2" - Brushed Bronze

META

36 607 661    Product version from 7/1/2023

mm [inches]

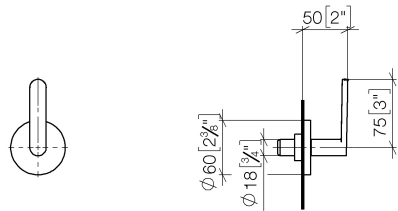

Codes & Standards

ASME A112.18.1	cUPC	DIN 4109	ISO 3822
Scottish Water Byelaws	UK Water Supply Regulations	Ü-Zeichen	

Certificates and sustainability

LGA_38	LGA_29	WRAS_2010	LGA_29	IAPMO_4976 (
--------	--------	-----------	--------	--------------

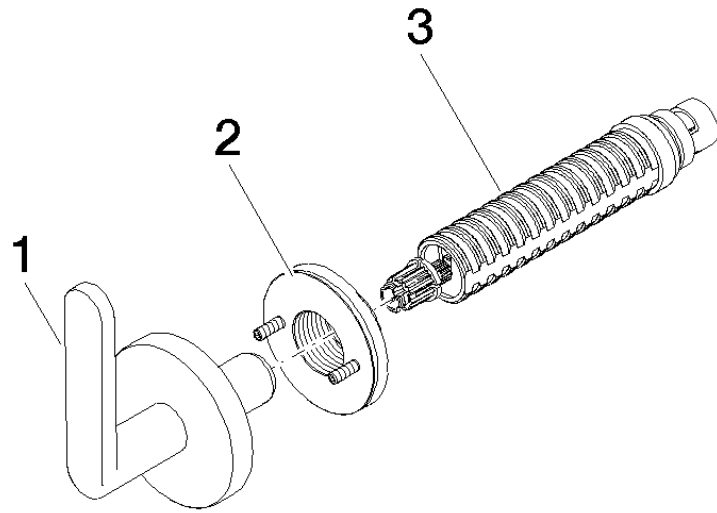

Spare parts list

No.	Item Number	Name	Quantity used	Delivery time
3	90 90 03 143 00 90	top	1.00	2
2	90 21 02 181 00 90	disc	1.00	2
1	90 20 66 014 04-42	handle	1.00	30