





**CL.1 Wall valve anti-clockwise closing hot 1/2" - Brushed Dark Platinum**

CL.1

36 607 707

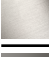

- rosette 60 x 60 mm
- with hot marking
- head part with cut-to-length spindle and sleeve
- WRAS 2010066

	Brushed Dark Platinum	36 607 707-99
	Chrome	36 607 707-00
	Brushed Platinum	36 607 707-06
	Dark Chrome	36 607 707-19
	Brushed Champagne (22kt Gold)	36 607 707-46
	Champagne (22kt Gold)	36 607 707-47

**Required miscellaneous**



- Wall valve 1/2" -** 35 607 970 90
- max. recess depth 150 mm
  - min. recess depth 105 mm



# CL.1 Wall valve anti-clockwise closing hot 1/2" - Brushed Dark Platinum

CL.1

36 607 707

mm [inches]

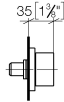

## Codes & Standards

ASME A112.18.1

cUPC

DIN 4109

EN 200

ISO 3822

Scottish Water  
Byelaws

UK Water Supply  
Regulations

Ü-Zeichen

## Certificates

IAPMO\_4976

DVGW\_DW-  
6501DN0

WRAS\_2010

LGA\_29

LGA\_29

36 607 707

Product version up to 10/14/2020

**Product version from 10/14/2020**

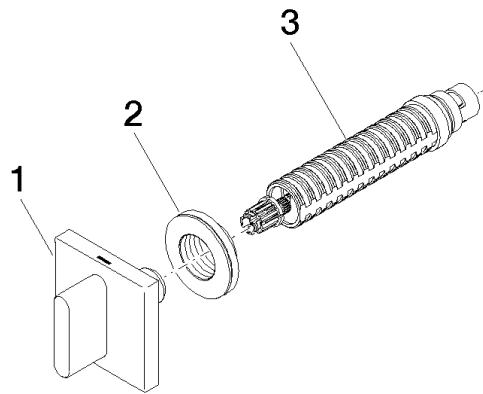



## CL.1 Wall valve anti-clockwise closing hot 1/2" - Brushed Dark Platinum

CL.1

36 607 707

### Spare parts list

Product version up to 10/14/2020

### Product version from 10/14/2020

No.	Item Number	Name	Quantity used	Delivery time
	90 20 70 051 03-99	handle ( hot )	3	30