







CL.1 Wall valve clockwise closing 3/4" - Chrome

CL.1

36 608 705 Product version up to 10/14/2020



- rosette 60 x 60 mm
- without marking
- head part with cut-to-length spindle and sleeve
- WRAS

	Chrome	36 608 705-00
	Brushed Platinum	36 608 705-06
	Dark Chrome	36 608 705-19
	Brushed Champagne (22kt Gold)	36 608 705-46
	Champagne (22kt Gold)	36 608 705-47
	Brushed Dark Platinum	36 608 705-99

Required miscellaneous

Wall valve 3/4" -		35 608 970 90
	•max. recess depth 150 mm	
	•min. recess depth 105 mm	



CL.1 Wall valve clockwise closing 3/4" - Chrome

CL.1

36 608 705 Product version up to 10/14/2020

mm [inches]



Codes & Standards

ASME A112.18.1	cUPC	Scottish Water Byelaws	UK Water Supply Regulations
----------------	------	---------------------------	--------------------------------

Certificates and sustainability

WRAS_2010 IAPMO_4976 (

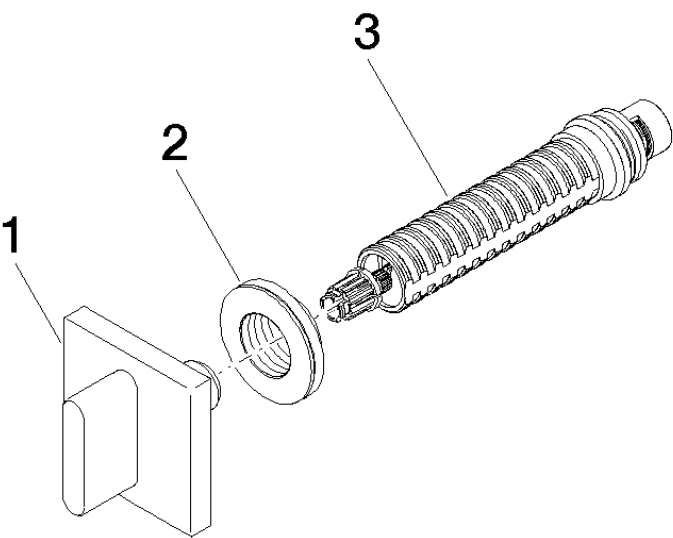

Spare parts list

No.	Item Number	Name	Quantity used	Delivery time
1	90 20 70 051 01-00	handle	1.00	10
2	09 21 02 108 90	disc	1.00	60
3	90 90 03 127 00 90	top	1.00	2