





CL.1 Wall valve clockwise closing 1/2" - Brushed Dark Platinum

CL.1

36 627 705    Product version up to 10/14/2020

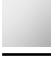

- with CASCADE structure
- rosette 60 x 60 mm
- without marking
- head part with cut-to-length spindle and sleeve
- WRAS

	Brushed Dark Platinum	36 627 705-99
	Chrome	36 627 705-00
	Brushed Platinum	36 627 705-06
	Dark Chrome	36 627 705-19
	Brushed Champagne (22kt Gold)	36 627 705-46
	Champagne (22kt Gold)	36 627 705-47

Required miscellaneous

	<b>Wall valve 1/2" -</b> •max. recess depth 150 mm •min. recess depth 105 mm	35 607 970 90
---	--	---------------

CL.1 Wall valve clockwise closing 1/2" - Brushed Dark Platinum

CL.1

36 627 705    Product version up to 10/14/2020

mm [inches]



Codes & Standards			
ASME A112.18.1	cUPC	DIN 4109	EN 1111
EN 200	ISO 3822	Scottish Water Byelaws	UK Water Supply Regulations
Ü-Zeichen			

Certificates and sustainability				
DVGW_DW-6501DN0	WRAS_2011	LGA_29	WRAS_2010	DVGW_DW-6512DN0
LGA_29	IAPMO_4976 (			

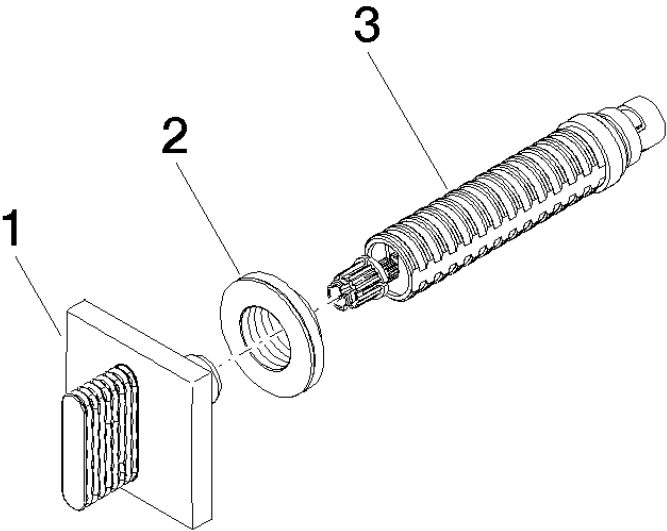

Spare parts list

No.	Item Number	Name	Quantity used	Delivery time
2	09 21 02 108 90	disc	1.00	60
1	90 20 70 053 01-99	handle	1.00	20
3	90 90 03 143 00 90	top	1.00	2