





CL.1 Wall valve anti-clockwise closing hot 1/2" - Brushed Platinum

CL.1

36 627 707    Product version up to 10/14/2020



- with CASCADE structure
- rosette 60 x 60 mm
- with hot marking
- head part with cut-to-length spindle and sleeve
- WRAS

	Brushed Platinum	36 627 707-06
	Chrome	36 627 707-00
	Dark Chrome	36 627 707-19
	Brushed Champagne (22kt Gold)	36 627 707-46
	Champagne (22kt Gold)	36 627 707-47
	Brushed Dark Platinum	36 627 707-99

Required miscellaneous

	<b>Wall valve 1/2" -</b>	35 607 970 90
	<ul style="list-style-type: none"> <li>•max. recess depth 150 mm</li> <li>•min. recess depth 105 mm</li> </ul>	

CL.1 Wall valve anti-clockwise closing hot 1/2" - Brushed Platinum

CL.1

36 627 707    Product version up to 10/14/2020

mm [inches]

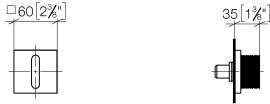

Codes & Standards			
ASME A112.18.1	cUPC	DIN 4109	EN 200
ISO 3822	Scottish Water Byelaws	UK Water Supply Regulations	Ü-Zeichen

Certificates and sustainability				
DVGW_DW-6501DN0	LGA_29	WRAS_2010	LGA_29	IAPMO_4976 (

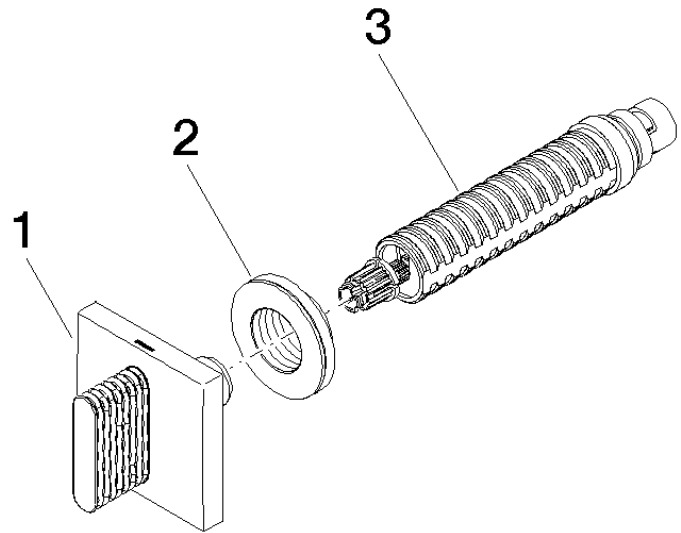

Spare parts list

No.	Item Number	Name	Quantity used	Delivery time
1	90 20 70 053 03-06	handle ( hot )	1.00	10
3	90 90 03 142 00 90	top	1.00	2
2	09 21 02 108 90	disc	1.00	60