









MEM Wall-mounted basin mixer without pop-up waste - Brushed Champagne (22kt Gold)

MEM

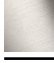
36 712 782 Product version from 10/27/2020



- 200mm projection
- fixed spout
- rectangular, air-enriched flow
- hole diameter valve 40 mm
- hole diameter spout 40 mm
- individual rosettes 60 x 60 mm
- max. flow 5.7 l/min
- lead-free
- This product can help a building meet the requirements of Green Building Rating Systems, e.g. LEED®, BREEAM®, DGNB
- WRAS

	Brushed Champagne (22kt Gold)	36 712 782-46
	Chrome	36 712 782-00
	Brushed Platinum	36 712 782-06
	Platinum	36 712 782-08
	Dark Chrome	36 712 782-19
	Brushed Durabronze (23kt Gold)	36 712 782-28
	Champagne (22kt Gold)	36 712 782-47
	Brushed Dark Platinum	36 712 782-99

Required miscellaneous



- Concealed wall-mounted mixer centred spout -** 35 700 970 90
- max. recess depth 150 mm
 - min. recess depth 110 mm

Required miscellaneous



- Concealed wall-mounted mixer variable positioning -** 35 720 970 90
- min. recess depth 110 mm
 - max. recess depth 150 mm

MEM Wall-mounted basin mixer without pop-up waste - Brushed Champagne (22kt Gold)

MEM

36 712 782 Product version from 10/27/2020
mm [inches]

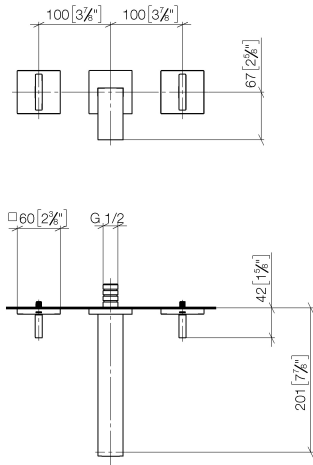

Flow rate chart



Codes & Standards

DIN 4109

ISO 3822

Scottish Water
Byelaws

UK Water Supply
Regulations

Ü-Zeichen



MEM Wall-mounted basin mixer without pop-up waste - Brushed Champagne (22kt Gold)

MEM

36 712 782 Product version from 10/27/2020

Certificates and sustainability

LGA_18

WRAS_2204

MEM Wall-mounted basin mixer without pop-up waste - Brushed Champagne (22kt Gold)

MEM

36 712 782 Product version from 10/27/2020

