

## Single sink - Brushed Stainless Steel

---

38 551 004



- installation, on top or flush
- 550 x 400 mm
- sink depth 175 mm
- suitable for base units 600 mm
- Radius 15 mm

**Drain and overflow set not included in the scope of supply. See Required miscellaneous.**

Drain and overflow set not included in the scope of supply. See Required miscellaneous.

### Required miscellaneous



**Pop-up waste and overflow with electronic control** 10 410 004-86

### Required miscellaneous



**Basin Waste mechanical** 10 405 004-86

## Single sink - Brushed Stainless Steel

---

38 551 004

mm [inches]  
1:10

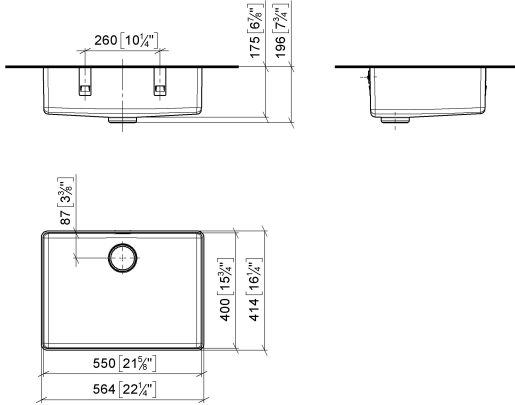

## Certificates

---

Leistungserklärung\_ declaration\_of\_perfo  
DOD rmance\_DOD