

TARA Bath grip - Chrome

TARA

83 030 892 Product version from 4/1/2024



- gauge 300 mm
- width 355mm
- height 55 mm
- rosette Ø 55 mm
- 80mm projection

	Chrome	83 030 892-00
	Brushed Platinum	83 030 892-06
	Platinum	83 030 892-08
	Dark Chrome	83 030 892-19
	Brushed Durabrass (23kt Gold)	83 030 892-28
	Matte Black	83 030 892-33
	Brushed Bronze	83 030 892-42
	Brushed Champagne (22kt Gold)	83 030 892-46
	Champagne (22kt Gold)	83 030 892-47
	Brushed Chrome	83 030 892-93
	Brushed Dark Platinum	83 030 892-99

mm [inches]



Codes & Standards

TÜV-Zeichen

Certificates and sustainability

TÜV_B0358530023 TÜV_B0358530023

83 030 892 Product version from 4/1/2024

Parts for other
finishes can be found
here: [Brushed](#)
[Platinum](#)

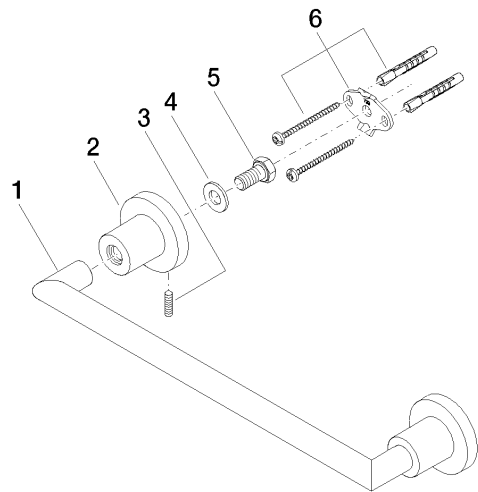

Spare parts list

No.	Item Number	Name	Quantity used	Delivery time
	6 05 17 20 739 00 90	fixing set	2.00	2
	1 05 28 22 587 00-00	holder	1.00	10
	2 08 17 89 505-00	holder	2.00	10
	4 09 30 11 046 90	disc	2.00	2
	3 04 31 11 113 00 90	pin	2.00	2
	5 09 30 30 071 90	screw	2.00	2