







Towel warmer , 4-fold , projection left , without control element - Brushed Champagne (22kt Gold)
SERIES SPECIFIC

|            |  |   |  |
|------------|--|---|--|
| 83 304 980 | Product version from 4/1/2025  |   |  |
|            | <ul style="list-style-type: none"> <li>gauge 120 mm</li> <li>width 600mm</li> <li>height 420 mm</li> <li>rosette 60 x 60 mm</li> <li>63mm projection</li> <li>Degree of protection IP 44, CE marking</li> <li>Output per towel bar: 15 watts</li> <li>Rated voltage: 220 - 240 V AC</li> </ul> |  Brushed Champagne (22kt Gold) 83 304 980-46 |  |
|            |  |  Chrome 83 304 980-00                        |  |
|            |  |  Dark Chrome 83 304 980-19                   |  |
|            |  |  Matte Black 83 304 980-33                   |  |
|            |  |  Brushed Chrome 83 304 980-93                |  |
|            |  |  Brushed Dark Platinum 83 304 980-99         |  |



**Without control element**  
**Activation must be handled by the customer**  
**Note: Different conditioning.**  
  
Without control element  
Activation must be handled by the customer  
Note: Different conditioning.

Required miscellaneous



**Concealed wall installation box for 35 311 970 90 towel warmer , 4-fold , without control element -**  
•min. recess depth 70 mm  
•max. recess depth 105 mm

# Towel warmer , 4-fold , projection left , without control element - Brushed Champagne (22kt Gold)

SERIES SPECIFIC

83 304 980 Product version from 4/1/2025  
mm [inches]

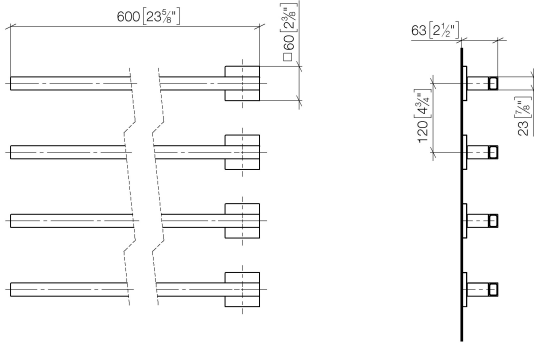

**Towel warmer , 4-fold , projection left , without control element - Brushed  
Champagne (22kt Gold)**

SERIES SPECIFIC

83 304 980 Product version from 4/1/2025

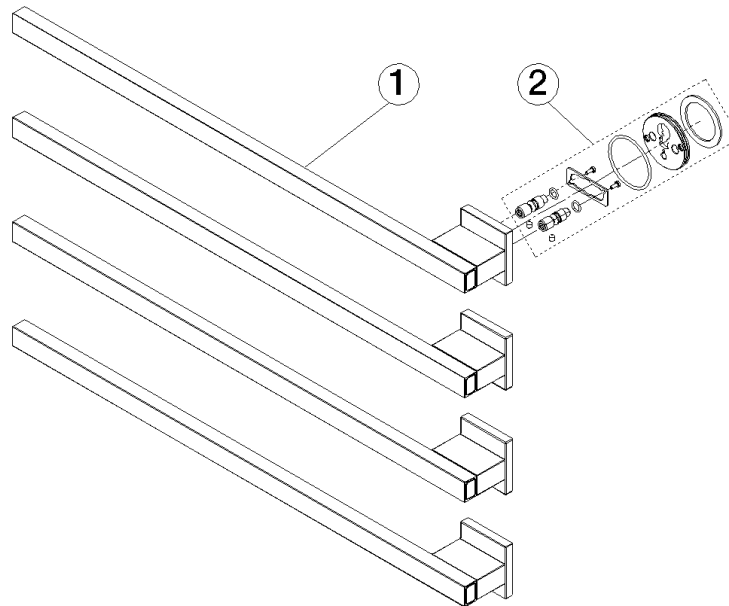

## Spare parts list

| No.  | Item Number        | Name       | Quantity used | Delivery time |
|--|--------------------|------------|---------------|---------------|
| 1  | 90 17 98 561 00-46 | holder     | 1.00          | -             |
| Spare part can no longer be ordered, please order the replacement item |                    |            |               |               |
| 2  | 90 30 30 252 00 90 | fixing set | 1.00          | -             |
| Spare part can no longer be ordered, please order the replacement item |                    |            |               |               |