









Siebventil 1 1/4" - Messing (23kt Gold)

IMO

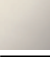
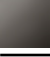
10 110 970

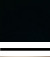

Passt zu: IMO, LULU, MADISON, MEM, TARA, CL.1, LISSÉ, VAIA, META, CYO

	Messing (23kt Gold)	10 110 970-09
	Chrom	10 110 970-00
	Platin gebürstet	10 110 970-06
	Platin	10 110 970-08
	Dark Chrome	10 110 970-19
	Messing gebürstet (23kt Gold)	10 110 970-28
	Schwarz matt	10 110 970-33
	Champagne gebürstet (22kt Gold)	10 110 970-46
	Champagne (22kt Gold)	10 110 970-47
	Chrom gebürstet	10 110 970-93
	Dark Platinum gebürstet	10 110 970-99



Siebventil 1 1/4" - Messing (23kt Gold)

IMO

10 110 970

Nur für Becken ohne Überlauf geeignet.

10 110 970

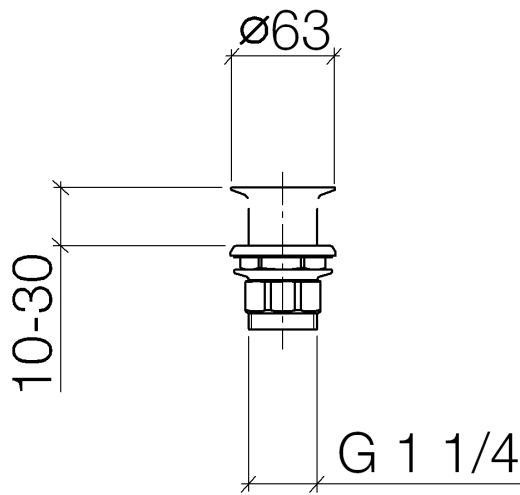

10 110 970

Ersatzteile für die
anderen
Oberflächenvarianten
finden Sie hier:
Chrom

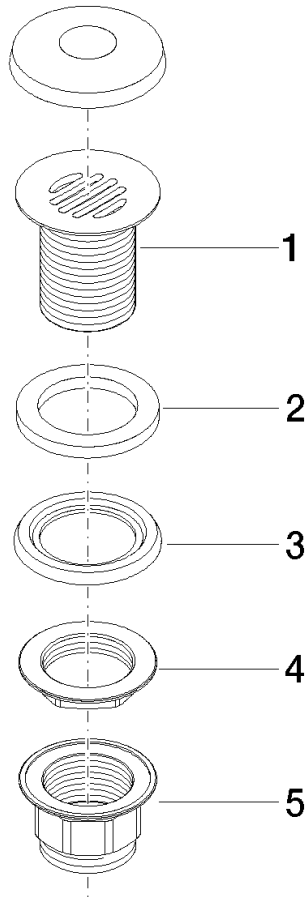

Ersatzteilstückliste

Nr.	Artikelnummer	Benennung	Verbaumenge	Lieferzeit
1	09 11 01 025-09	Kelch	1	60
2	09 14 05 039 90	Dichtung	1	2
3	09 14 03 025 90	Dichtung	1	2
4	09 23 10 017 90	Mutter	1	2
5	09 23 10 020-09	Mutter	1	60