













Ablaufgarnitur mit Druckverschluss 1 1/4" - Platin gebürstet

IMO

10 125 970



Passt zu: IMO, LULU, MADISON, MEM, TARA, CL.1, LISSÉ, VAIA, META, CYO

| | | |
|-------------------------------------------------------------------------------------|-----------------------------------------|---------------|
|  | Platin gebürstet | 10 125 970-06 |
|  | Chrom | 10 125 970-00 |
|  | Platin | 10 125 970-08 |
|  | Messing (23kt Gold) | 10 125 970-09 |
|  | Dark Chrome | 10 125 970-19 |
|  | Messing gebürstet (23kt Gold) | 10 125 970-28 |
|  | Schwarz matt | 10 125 970-33 |
|  | Platin / Platin gebürstet | 10 125 970-36 |
|  | Messing / Messing gebürstet (23kt Gold) | 10 125 970-38 |
|  | Champagne gebürstet (22kt Gold) | 10 125 970-46 |
|  | Champagne (22kt Gold) | 10 125 970-47 |
|  | Chrom gebürstet | 10 125 970-93 |
|  | Dark Platinum gebürstet | 10 125 970-99 |



Ablaufgarnitur mit Druckverschluss 1 1/4" - Platin gebürstet

IMO

10 125 970

Nur für Becken mit Überlauf geeignet.

10 125 970

mm [inches]

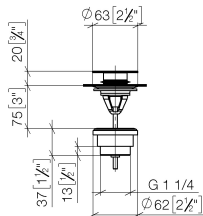

10 125 970

Ersatzteile für die
anderen
Oberflächenvarianten
finden Sie hier:
Chrom

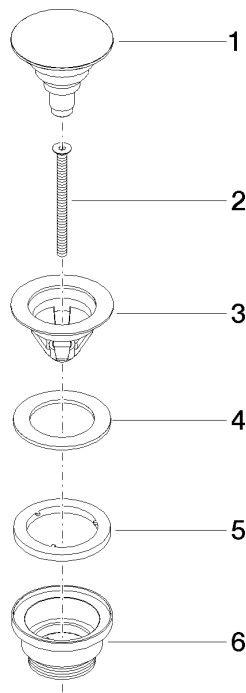

Ersatzteilstückliste

| Nr. | Artikelnummer | Benennung | Verbaumenge | Lieferzeit |
|-----|--------------------|-----------|-------------|------------|
| 1 | 04 31 20 096 00-06 | Stopfen | 1 | 10 |
| 2 | 09 30 30 179 90 | Schraube | 1 | 2 |
| 3 | 09 11 01 038-06 | Kelch | 1 | 10 |
| 4 | 09 14 05 061 90 | Dichtung | 1 | 2 |
| 5 | 09 14 03 153 90 | Dichtung | 1 | 2 |
| 6 | 09 11 10 156-06 | Anschluss | 1 | 10 |