





IMO Bath spout for wall mounting - Brushed Platinum
IMO

13 801 670

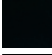

- 200mm projection
- rectangular normal flow
- hole diameter 37 mm
- 1/2" connection
- max. flow 25.1 l/min at 3 bar flow pressure

	Brushed Platinum	13 801 670-06
	Chrome	13 801 670-00
	Dark Chrome	13 801 670-19
	Matte Black	13 801 670-33
	Brushed Chrome	13 801 670-93

Recommended miscellaneous



- Concealed wall elbow -
35 085 970 90
- max. recess depth 163 mm
 - min. recess depth 90 mm

13 801 670

mm [inches]

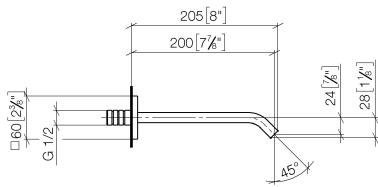

Flow rate chart



Certificates

IAPMO_4976 (6). WRAS_2005002.

13 801 670

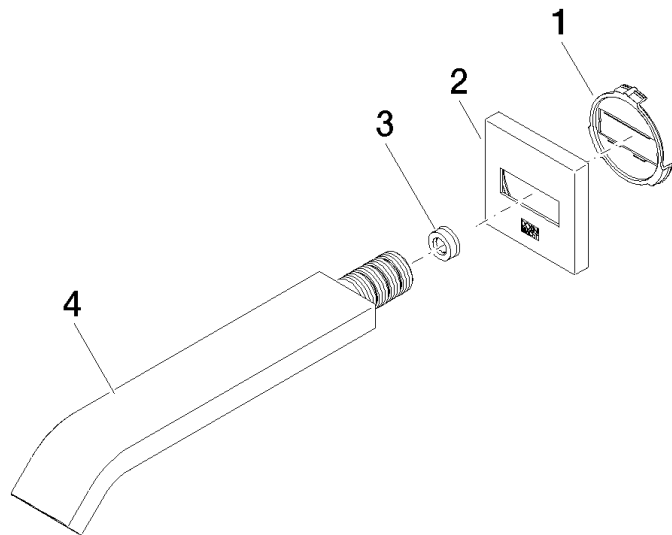

Spare parts list

No.	Item Number	Name	Quantity used	Delivery time
1	09 18 40 139 90	base	1	2
2	09 27 67 008-06	rosette	1	10
3	09 23 01 057 90	flow reducer	1	2
4	04 28 22 241 00-06	spout	1	10